

# Application to vary a premises licence under the Licensing Act 2003

## PLEASE READ THE FOLLOWING INSTRUCTIONS FIRST

Before completing this form please read the guidance notes at the end of the form.  
If you are completing this form by hand please write legibly in block capitals. In all cases ensure that your answers are inside the boxes and written in black ink. Use additional sheets if necessary.  
You may wish to keep a copy of the completed form for your records.

**We Greene King Brewing and Retailing Limited being the premises licence holder, apply to vary a premises licence under section 34 of the Licensing Act 2003 for the premises described in Part 1 below.**

### Premises Licence Number

PL(A)0613

### Part 1 – Premises details

Postal address of premises or, if none, ordnance survey map reference or description Village Inn, Lake Road	
Post town Bowness-on-Windermere	Post code LA23 3DE

Telephone number of premises (if any)

Non-domestic rateable value of premises

£151,850 (band E)

### Part 2 – Applicant Details

Daytime contact telephone number

Email address  
(optional)

Current postal  
address if  
different from  
premises address

Westgate Brewery

Post Town

Bury St Edmunds

Postcode

IP33 1QT

**Part 3 – Variation**

Do you want the proposed variation to have effect as soon as possible?

Please tick ✓ yes

If not do you want the variation to take effect from

Day    Month    Year

--	--	--	--	--	--	--	--

If your proposed variation would mean that 5,000 or more people are expected to attend the premises at any one time, please state the number expected to attend.

N/A

Do you want the proposed variation to have effect in relation to the introduction of the late night levy?  
(Please see Guidance Note 1)

yes     no

**Please describe briefly the nature of the proposed variation (please read guidance note 2)**

The premises has the benefit of Premises Licence number PL(A)0613 and external areas currently used for the consumption of food and drink/alcohol. These external areas are also currently licensed the provision of recorded music until 22.30 daily.

The variation seeks to license the external areas for the sale of alcohol, principally to permit the use of a mobile bar servery.

Drawing *PR 101* is deposited with the application and this shows the extent of the outside areas to be licensed for the sale of alcohol. In addition, the drawing shows the correct internal layout at the premises.

For the avoidance of doubt, all existing licensable activities extend to the internal areas edged red on the deposited plan. The external areas edged red will be licensed for recorded music (as existing) and the sale of alcohol.

It is not anticipated that the application will have an adverse impact on the licensing objectives. No amendments are proposed to the general method of operation of the premises or the trading hours for licensable activities and accordingly Boxes A – I have not been completed as these will remain the same as existing. Box J has been completed with regard to the proposed external use for sale of alcohol.

## Part 4 Operating Schedule

Please complete those parts of the Operating Schedule below which would be subject to change if this application to vary is successful.

Please tick ✓ yes

### **Provision of regulated entertainment (Please see guidance note 3)**

- a) Plays (if ticking yes, fill in box A)
- b) Films (if ticking yes, fill in box B)
- c) indoor sporting events (if ticking yes, fill in box C)
- d) boxing or wrestling entertainment (if ticking yes, fill in box D)
- e) live music (if ticking yes, fill in box E)
- f) recorded music (if ticking yes, fill in box F)
- g) performances of dance (if ticking yes, fill in box G)
- h) anything of a similar description to that falling within (e), (f) or (g) (if ticking yes, fill in box H)

**Provision of late night refreshment** (if ticking yes, fill in box I)

**Sale by retail of alcohol** (if ticking yes, fill in box J)

**In all cases complete boxes K, L and M**

## A

<b>Plays</b> Standard days and timings (please read guidance note 8)			<b>Will the performance of a play take place indoors or outdoors or both – please tick {Y}</b> (please read guidance note 4).	Indoors	
Day	Start	Finish		Outdoors	
Mon			<b>Please give further details here</b> (please read guidance note 5)	Both	
Tue					
Wed			<b>State any seasonal variations for performing plays</b> (please read guidance note 6)		
Thur					
Fri			<b>Non standard timings. Where you intend to use the premises for the performance of plays at different times to those listed in the column on the left, please list</b> (please read guidance note 7)		
Sat					
Sun					

## B

<b>Films</b> Standard days and timings (please read guidance note 8)			<b>Will the exhibition of films take place indoors or outdoors or both – please tick {Y}</b> (please read guidance note 4).	Indoors	
Day	Start	Finish		Outdoors	
Mon			<b>Please give further details here</b> (please read guidance note 5)	Both	
Tue					
Wed			<b>State any seasonal variations for the exhibition of films</b> (please read guidance note 6)		
Thur					
Fri			<b>Non standard timings. Where you intend to use the premises for the exhibition of films at different times to those listed in the column on the left, please list</b> (please read guidance note 7)		
Sat					
Sun					

**C**

<b>Indoor sporting events</b> Standard days and timings (please read guidance note 8)			<b>Please give further details</b> (please read guidance note 5)
Day	Start	Finish	
Mon			
Tue			
Wed			
Thur			
Fri			
Sat			
Sun			

<b>Indoor sporting events</b> Standard days and timings (please read guidance note 8)			<b>State any seasonal variations for indoor sporting events</b> (please read guidance note 6)
Day	Start	Finish	
Mon			
Tue			
Wed			
Thur			
Fri			
Sat			
Sun			

<b>Indoor sporting events</b> Standard days and timings (please read guidance note 8)			<b>Non standard timings. Where you intend to use the premises for indoor sporting events at different times to those listed in the column on the left, please list</b> (please read guidance note 7)
Day	Start	Finish	
Mon			
Tue			
Wed			
Thur			
Fri			
Sat			
Sun			

**D**

<b>Boxing or wrestling entertainment</b> Standard days and timings (please read guidance note 8)			<b>Will the boxing or wrestling entertainment take place indoors or outdoors or both - please tick (Y)</b> (please read guidance note 4).	Indoors	
Day	Start	Finish		Outdoors	
Mon					
Tue					
Wed					
Thur					
Fri					
Sat					
Sun					

<b>Boxing or wrestling entertainment</b> Standard days and timings (please read guidance note 8)			<b>Will the boxing or wrestling entertainment take place indoors or outdoors or both - please tick (Y)</b> (please read guidance note 4).	Indoors		
Day	Start	Finish		Outdoors		
Mon						
Tue						
Wed						
Thur						
Fri						
Sat						
Sun						

<b>Boxing or wrestling entertainment</b> Standard days and timings (please read guidance note 8)			<b>Will the boxing or wrestling entertainment take place indoors or outdoors or both - please tick (Y)</b> (please read guidance note 4).	Indoors		
Day	Start	Finish		Outdoors		
Mon						
Tue						
Wed						
Thur						
Fri						
Sat						
Sun						

<b>Boxing or wrestling entertainment</b> Standard days and timings (please read guidance note 8)			<b>Will the boxing or wrestling entertainment take place indoors or outdoors or both - please tick (Y)</b> (please read guidance note 4).	Indoors		
Day	Start	Finish		Outdoors		
Mon						
Tue						
Wed						
Thur						
Fri						
Sat						
Sun						

**E**

<b>Live music</b> Standard days and timings (please read guidance note 8)			<b>Will the performance of live music take place <u>Indoors</u> or <u>outdoors</u> or <u>both</u> – please tick {Y}</b> (please read guidance note 4).	Indoors	
Day	Start	Finish		Outdoors	
Mon			<b>Please give further details here</b> (please read guidance note 5)	Both	
Tue					
Wed			<b>State any seasonal variations for the performance of live music</b> (please read guidance note 6)		
Thur					
Fri			<b>Non standard timings. Where you intend to use the premises for the performance of live music at different times to those listed in the column on the left, please list</b> (please read guidance note 7)		
Sat					
Sun					

**F**

<b>Recorded music</b> Standard days and timings (please read guidance note 8)			<b>Will the playing of recorded music take place <u>Indoors</u> or <u>outdoors</u> or <u>both</u> – please tick {Y}</b> (please read guidance note 4).	Indoors	
Day	Start	Finish		Outdoors	
Mon			<b>Please give further details here</b> (please read guidance note 5)	Both	
Tue					
Wed			<b>State any seasonal variations for playing recorded music</b> (please read guidance note 6)		
Thur					
Fri			<b>Non standard timings. Where you intend to use the premises for the playing of recorded music entertainment at different times to those listed in the column on the left, please list</b> (please read guidance note 7)		
Sat					
Sun					

## G

<b>Performances of dance</b> Standard days and timings (please read guidance note 8)			<b><u>Will the performance of dance take place indoors or outdoors or both – please tick {Y}</u></b> (please read guidance note 4).	Indoors	
Day	Start	Finish		Outdoors	
Mon			<b><u>Please give further details here</u></b> (please read guidance note 5)	Both	
Tue					
Wed			<b><u>State any seasonal variations for the performance of dance</u></b> (please read guidance note 6)		
Thur					
Fri			<b><u>Non standard timings. Where you intend to use the premises for the performance of dance entertainment at different times to those listed in the column on the left, please list</u></b> (please read guidance note 7)		
Sat					
Sun					

## H

<b>Anything of a similar description to that falling within (e), (f) or (g)</b> Standard days and timings (please read guidance note 8)			<b><u>Please give a description of the type of entertainment you will be providing</u></b>		
Day	Start	Finish	<b><u>Will this entertainment take place indoors or outdoors or both – please tick {Y}</u></b> (please read guidance note 4).	Indoors	
Mon				Outdoors	
Tue				Both	
Wed			<b><u>Please give further details here</u></b> (please read guidance note 5)		
Thur					
Fri			<b><u>State any seasonal variations for entertainment of a similar description to that falling within (e), (f) or (g)</u></b> (please read guidance note 6)		
Sat					
Sun			<b><u>Non standard timings. Where you intend to use the premises for the entertainment of similar description to that falling within (e), (f) or (g) at different times to those listed in the column on the left, please list</u></b> (please read guidance note 7)		

**I**

<b>Late night refreshment</b> Standard days and timings (please read guidance note 8)			<b>Will the provision of late night refreshment take place indoors or outdoors or both – please tick {Y}</b> (please read guidance note 4).	Indoors	
Day	Start	Finish		Outdoors	
Mon			<b>Please give further details here</b> (please read guidance note 5)	Both	
Tue					
Wed			<b>State any seasonal variations for the provision of late night refreshment</b> (please read guidance note 6)		
Thur					
Fri			<b>Non standard timings. Where you intend to use the premises for the provision of late night refreshment at different times, to those listed in the column on the left, please list</b> (please read guidance note 7)		
Sat					
Sun					

**J**

<b>Supply of alcohol</b> Standard days and timings (please read guidance note 8)			<b>Will the supply of alcohol be for consumption</b> <b>(Please tick box Y)</b> (please read guidance note 9)	On the premises	
Day	Start	Finish		Off the premises	
Mon	As existing	As existing	N/A – save as below	Both	✓
Tue	As existing	As existing			
Wed	As existing	As existing	<b>Non-standard timings. Where you intend to use the premises for the supply of alcohol at different times to those listed in the column on the left, please list</b> (please read guidance note 7)		
Thur	As existing	As existing			
Fri	As existing	As existing			
Sat	As existing	As existing			
Sun	As existing	As existing	Non-standard timings will continue to apply as per the existing Premises Licence.		

**K**

**Please highlight any adult entertainment or services, activities, other entertainment or matters ancillary to the use of the premises that may give rise to concern in respect of children** (please read guidance note 10)

None.



L

<b>Hours premises are open to the public</b> Standard days and timings (please read guidance note 8)			<b>State any seasonal variation</b> (please read guidance note 6)
Day	Start	Finish	N/A – save as below
Mon	As existing	As existing	
Tue	As existing	As existing	
Wed	As existing	As existing	
Thur	As existing	As existing	
Fri	As existing	As existing	
Sat	As existing	As existing	
Sun	As existing	As existing	

**Non standard timings. Where you intend to use the premises to be open to the public at different times from those listed in the column on the left, please list** (please read guidance note 7)

Non-standard timings will continue to apply as per the existing Premises Licence.

**Please identify those conditions currently imposed on the licence which you believe could be removed as a consequence of the proposed variation you are seeking**

None.

Please tick ✓ yes

I have enclosed the premises licence



I have enclosed the relevant part of the premises licence



If you have not ticked one of these boxes please fill in reasons for not including the licence, or part of it, below

Reasons why I have failed to enclose the premises licence or relevant part of premises licence

## M

Describe any additional steps you intend to take to promote the four licensing objectives as a result of the proposed variation:

**a) General – all four licensing objectives (b, c, d, e) (please read guidance note 11)**

I have undertaken my own risk assessment to take the following proposed steps.

The variation is not anticipated to adversely affect the four licensing objectives and the conditions to remain on the Licence are assessed to be sufficient.

No new steps have been identified in relation to the four licensing objectives save as below.

**b) The prevention of crime and disorder**

No further risks have been identified which need to be addressed.

**c) Public safety**

No further risks have been identified which need to be addressed

**d) The prevention of public nuisance**

No further risks have been identified which need to be addressed.

**e) The protection of children from harm**

The restrictions set out in the Licensing Act 2003 will apply. No unusual or additional risks of harm to children have been identified.

- I have made or enclosed payment of the fee; or
- I have not made or enclosed payment of the fee because this application has been made in relation to the introduction of the late night levy.
- I have sent copies of this application and the plan to responsible authorities and others where applicable
- I understand that I must now advertise my application
- I have enclosed the premises licence or relevant part of it or explanation
- I understand that if I do not comply with the above requirements my application will be rejected

**IT IS AN OFFENCE, UNDER SECTION 158 OF THE LICENSING ACT 2003, TO MAKE A FALSE STATEMENT IN OR IN CONNECTION WITH THIS APPLICATION. THOSE WHO MAKE A FALSE STATEMENT MAY BE LIABLE ON SUMMARY CONVICTION TO A FINE OF ANY AMOUNT.**

**Part 5 – Signatures** (please read guidance note 12)

**Signature of applicant (the current premises licence holder) or applicant’s solicitor or other duly authorised agent.** (Please read guidance note 13). **If signing on behalf of the applicant please state in what capacity.**

Signature: [Redacted] .....

Date: *4/5/22* .....

Capacity: Solicitors.....

**Where the premises licence is jointly held signature of 2<sup>nd</sup> applicant (the current premises licence holder) or 2<sup>nd</sup> applicant’s solicitor or other authorised agent.** (Please read guidance note 14). **If signing on behalf of the applicant please state in what capacity.**

Signature: .....

Date: .....

Capacity: .....

<b>Contact name (where not previously given) and address for correspondence associated with this application (please read guidance note 15)</b>	
John Gaunt & Partners [Redacted]	
<b>Post town</b> [Redacted]	<b>Post code</b> [Redacted]
<b>Telephone number (if any)</b> [Redacted]	
<b>If you would prefer us to correspond with you by email your email address (optional)</b> [Redacted]	

**Notes for Guidance**

**This application cannot be used to vary the licence so as to extend the period for which the licence has effect or to vary substantially the premises to which it relates. If you wish to make that type of change to the premises licence, you should make a new premises licence application under section 17 of the Licensing Act 2003.**

1. You do not have to pay a fee if the only purpose of the variation for which you are applying is to avoid becoming liable for the late night levy
2. Describe the premises. For example, the type of premises, its general situation and layout and any other information which could be relevant to the licensing objectives. Where your application includes off-supplies of alcohol and you intend to provide a place of consumption of these off-supplies of alcohol, you must include a description of where the place will be and its proximity to the premises.
3. In terms of specific regulated entertainments please note that:
  - Plays: no licence is required for performances between 08.00 and 23.00 on any day, provided that the audience does not exceed 500.
  - Films: no licence is required for 'not-for-profit' film exhibition held in community premises between 08.00 and 23.00 on any day provided that the audience does not exceed 500 and the organiser (a) gets consent to the screening from a person who is responsible for the premises; and (b) ensures that each such screening abides by age classification ratings.

- Indoor sporting events: no licence is required for performances between 08.00 and 23.00 on any day, provided that the audience does not exceed 1000.
  - Boxing or Wrestling Entertainment: no licence is required for a contest, exhibition or display of Greco-Roman wrestling, or freestyle wrestling between 08.00 and 23.00 on any day, provided that the audience does not exceed 1000. Combined fighting sports – defined as a contest, exhibition or display which combines boxing or wrestling with one or more martial arts – are licensable as a boxing or wrestling entertainment rather than an indoor sporting event.
  - Live music: no licence permission is required for:
    - a performance of unamplified live music between 08.00 and 23.00 on any day, on any premises.
    - a performance of amplified live music between 08.00 and 23.00 on any day on premises authorised to sell alcohol for consumption on those premises, provided that the audience does not exceed 500.
    - a performance of amplified live music between 08.00 and 23.00 on any day, in a workplace that is not licensed to sell alcohol on those premises, provided that the audience does not exceed 500.
    - a performance of amplified live music between 08.00 and 23.00 on any day, in a church hall, village hall, community hall, or other similar community premises, that is not licensed by a premises licence to sell alcohol, provided that (a) the audience does not exceed 500, and (b) the organiser gets consent for the performance from a person who is responsible for the premises.
    - a performance of amplified live music between 08.00 and 23.00 on any day, at the non-residential premises of (i) a local authority, or (ii) a school, or (iii) a hospital, provided that (a) the audience does not exceed 500, and (b) the organiser gets consent for the performance on the relevant premises from: (i) the local authority concerned, or (ii) the school or (iii) the health care provider for the hospital.
  - Recorded Music: no licence permission is required for:
    - any playing of recorded music between 08.00 and 23.00 on any day on premises authorised to sell alcohol for consumption on those premises, provided that the audience does not exceed 500.
    - any playing of recorded music between 08.00 and 23.00 on any day, in a church hall, village hall, community hall, or other similar community premises, that is not licensed by a premises licence to sell alcohol, provided that (a) the audience does not exceed 500, and (b) the organiser gets consent for the performance from a person who is responsible for the premises.
    - any playing of recorded music between 08.00 and 23.00 on any day, at the non-residential premises of (i) a local authority, or (ii) a school, or (iii) a hospital, provided that (a) the audience does not exceed 500, and (b) the organiser gets consent for the performance on the relevant premises from: (i) the local authority concerned, or (ii) the school proprietor or (iii) the health care provider for the hospital.
  - Dance: no licence is required for performances between 08.00 and 23.00 on any day, provided that the audience does not exceed 500. However, a performance which amounts to adult entertainment remains licensable.
  - Cross activity exemptions: no licence is required between 08.00 and 23.00 on any day, with no limit on audience size for:
    - any entertainment taking place on the premises of the local authority where the entertainment is provided by or on behalf of the local authority;
    - any entertainment taking place on the hospital premises of the health care provider where the entertainment is provided by or on behalf of the health care provider;
    - any entertainment taking place on the premises of the school where the entertainment is provided by or on behalf of the school proprietor; and
    - any entertainment (excluding films and a boxing or wrestling entertainment) taking place at a travelling circus, provided that (a) it takes place within a moveable structure that accommodates the audience, and (b) that the travelling circus has not been located on the same site for more than 28 consecutive days.
4. Where taking place in a building or other structure please tick as appropriate (Indoors may include a tent).
  5. For example state type of activity to be authorised, if not already stated, and give relevant further details, for example (but not exclusively) whether or not music will be amplified or unamplified.
  6. For example (but not exclusively), where the activity will occur on additional days during the summer months.
  7. For example (but not exclusively), where you wish the activity to go on longer on a particular day e.g. Christmas Eve.
  8. Please give timings in 24 hour clock (e.g. 16.00) and only give details for the days of the week when you intend the premises to be used for the activity.
  9. If you wish people to be able to consume alcohol on the premises, please tick 'on the premises'. If you wish people to be able to purchase alcohol to consume away from the premises, please tick 'off the premises'. If you wish people to be able to do both, please tick 'both'.
  10. Please give information about anything intended to occur at the premises or ancillary to the use of the premises which may give rise to concern in respect of children regardless of whether you intend children to have access to the premises, for example (but not exclusively) nudity or semi-nudity, films for restricted age groups or the presence of gaming machines.
  11. Please list here steps you will take to promote all four licensing objectives together.
  12. The application form must be signed.
  13. An applicant's agent (for example solicitor) may sign the form on their behalf provided that they have actual authority to do so.
  14. Where there is more than one applicant, each of the applicants or their respective agents must sign the application form.
  15. This is the address which we shall use to correspond with you about this application.

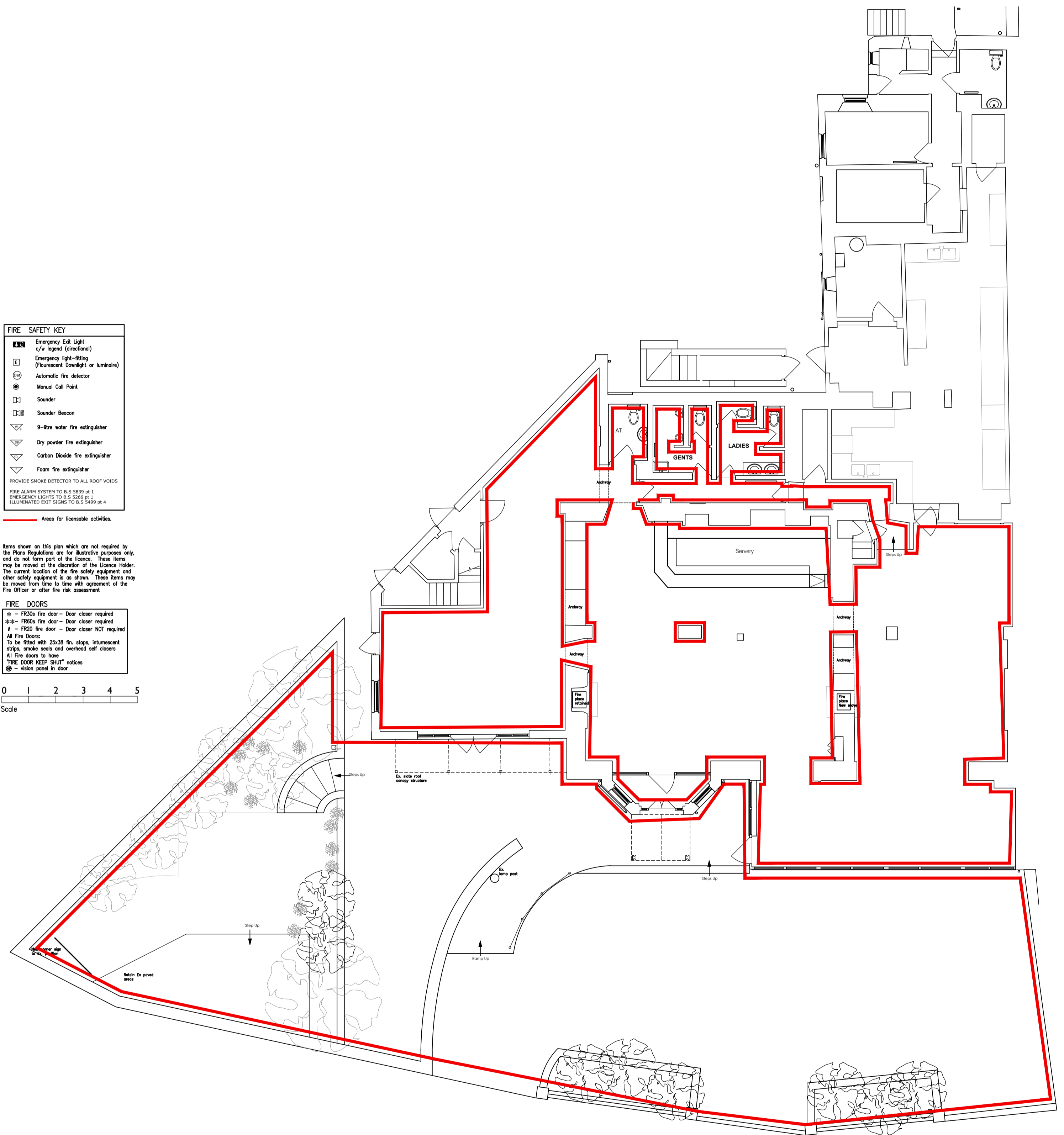

- FIRE SAFETY KEY**
- Emergency Exit Light  
c/w legend (directions)
  - Emergency light-fitting  
(Fluorescent Downlight or luminaire)
  - Automatic fire detector
  - Manual Call Point
  - Sounder
  - Sounder Beacon
  - S-litre water fire extinguisher
  - Dry powder fire extinguisher
  - Carbon Dioxide fire extinguisher
  - Foam fire extinguisher
- PROVIDE SMOKE DETECTOR TO ALL ROOF VOIDS  
 FIRE ALARM SYSTEM TO BS 5839 pt 1  
 EMERGENCY LIGHTS TO BS 5266 pt 1  
 ILLUMINATED EXIT SIGNS TO BS 5446 pt 4
- Areas for licensable activities.**

Items shown on this plan which are not required by the Plans Regulations are for illustrative purposes only, and do not form part of the contract. These items may be moved at the discretion of the Licence Holder. The current location of the fire safety equipment and other safety equipment is as shown. These items may be moved from time to time with agreement of the Fire Officer or other fire risk assessment.

- FIRE DOORS**
- FD30S fire door - Door closer required
  - FD30 fire door - Door closer required
  - FD20 fire door - Door closer NOT required
- All Fire Doors  
 To be fitted with 25x38 fin, stops, intumescent strips, smoke seals and overhead self closers  
 All Fire doors to have  
 "FIRE DOOR KEEP SHUT" notices  
 - vision panel in door

