

Application to vary a premises licence under the Licensing Act 2003

PLEASE READ THE FOLLOWING INSTRUCTIONS FIRST

Before completing this form please read the guidance notes at the end of the form. If you are completing this form by hand please write legibly in block capitals. In all cases ensure that your answers are inside the boxes and written in black ink. Use additional sheets if necessary.

You may wish to keep a copy of the completed form for your records.

We Sedbergh School

(Insert name(s) of applicant)

being the premises licence holder, apply to vary a premises licence under section 34 of the Licensing Act 2003 for the premises described in Part 1 below

Premises licence number

PL(A)034745

Part 1 – Premises Details

Postal address of premises or, if none, ordnance survey map reference or description
Malim Lodge
Sedbergh School
Cumbria

Post town

Sedbergh

Postcode

LA10 5RY

Telephone number at premises (if any)

01539 244019

Non-domestic rateable value of premises

£33,792

Part 2 – Applicant details

Daytime contact
telephone number

01539 244019

E-mail address (optional)

Current postal address if
different from premises
address

As above.

Post town

Postcode

Part 3 - Variation

Please tick as appropriate

Do you want the proposed variation to have effect as soon as possible? Yes

If not, from what date do you want the variation to take effect?

DD	MM	YYYY
<input type="text"/>	<input type="text"/>	<input type="text"/>

Do you want the proposed variation to have effect in relation to the introduction of the late night levy? (Please see guidance note 1) ☐ Yes ☐ No

Please describe briefly the nature of the proposed variation (Please see guidance note 2)

We wish to **add** an additional two buildings to our existing list of Buildings and Grounds.

These two buildings are:

Old Sports Hall
Hirst Centre

The timings on our existing licence will be applicable for these two buildings.

If your proposed variation would mean that 5,000 or more people are expected to attend the premises at any one time, please state the number expected to attend:

N/A

Please tick as appropriate

- I have enclosed the premises licence ☒
- I have enclosed the relevant part of the premises licence ☐

If you have not ticked one of these boxes, please fill in reasons for not including the licence or part of it below

Reasons why I have not enclosed the premises licence or relevant part of premises licence.

e) The protection of children from harm

Checklist:

- | | Please tick to indicate agreement |
|---|--|
| • I have made or enclosed payment of the fee; YES – BANK TRANSFER | <input checked="" type="checkbox"/> |
| • I have not made or enclosed payment of the fee because this application has been made in relation to the introduction of the late night levy. | <input type="checkbox"/> |
| • I have sent copies of this application and the plan to responsible authorities and others where applicable. | <input checked="" type="checkbox"/> |
| • I understand that I must now advertise my application. | <input checked="" type="checkbox"/> |
| • I have enclosed the premises licence or relevant part of it or explanation. | <input checked="" type="checkbox"/> |
| • I understand that if I do not comply with the above requirements my application will be rejected. | <input checked="" type="checkbox"/> |

IT IS AN OFFENCE, UNDER SECTION 158 OF THE LICENSING ACT 2003, TO MAKE A FALSE STATEMENT IN OR IN CONNECTION WITH THIS APPLICATION. THOSE WHO MAKE A FALSE STATEMENT MAY BE LIABLE ON SUMMARY CONVICTION TO A FINE OF ANY AMOUNT.

Part 5 – Signatures (please read guidance note 12)

Signature of applicant (the current premises licence holder) or applicant's solicitor or other duly authorised agent (please read guidance note 13). **If signing on behalf of the applicant, please state in what capacity.**

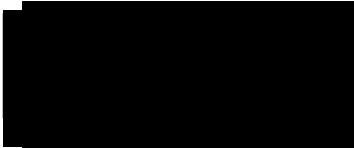
Signature	
Date	08/12/2021
Capacity	DPS

Where the premises licence is jointly held, signature of 2nd applicant (the current premises licence holder) or 2nd applicant's solicitor or other authorised agent (please read guidance note 14). **If signing on behalf of the applicant, please state in what capacity.**

Signature	
Date	
Capacity	Bursar Operations

Contact name (where not previously given) and address for correspondence associated with this application (please read guidance note 15)

As previously provided.

Post town

Post code

Telephone number (if any)

If you would prefer us to correspond with you by e-mail, your e-mail address (optional)

Notes for Guidance

This application cannot be used to vary the licence so as to extend the period for which the licence has effect or to vary substantially the premises to which it relates. If you wish to make that type of change to the premises licence, you should make a new premises licence application under section 17 of the Licensing Act 2003.

1. You do not have to pay a fee if the only purpose of the variation for which you are applying is to avoid becoming liable for the late night levy
2. Describe the premises. For example, the type of premises, its general situation and layout and any other information which could be relevant to the licensing objectives. Where your application includes off-supplies of alcohol and you intend to provide a place of consumption of these off-supplies of alcohol, you must include a description of where the place will be and its proximity to the premises.
3. In terms of specific regulated entertainments please note that:
 - Plays: no licence is required for performances between 08.00 and 23.00 on any day, provided that the audience does not exceed 500.
 - Films: no licence is required for 'not-for-profit' film exhibition held in community premises between 08.00 and 23.00 on any day provided that the audience does not exceed 500 and the organiser (a) gets consent to the screening from a person who is responsible for the premises; and (b) ensures that each such screening abides by age classification ratings.
 - Indoor sporting events: no licence is required for performances between 08.00 and 23.00 on any day, provided that the audience does not exceed 1000.
 - Boxing or Wrestling Entertainment: no licence is required for a contest, exhibition or display of Greco-Roman wrestling, or freestyle wrestling between 08.00 and 23.00 on any day, provided that the audience does not exceed 1000. Combined fighting sports – defined as a contest, exhibition or display which combines boxing or wrestling with one or more martial arts – are licensable as a boxing or wrestling entertainment rather than an indoor sporting event.
 - Live music: no licence permission is required for:
 - a performance of unamplified live music between 08.00 and 23.00 on any day, on any premises.
 - a performance of amplified live music between 08.00 and 23.00 on any day on premises authorised to sell alcohol for consumption on those premises, provided that the audience does not exceed 500.
 - a performance of amplified live music between 08.00 and 23.00 on any day, in a workplace that is not licensed to sell alcohol on those premises, provided that the audience does not exceed 500.

- a performance of amplified live music between 08.00 and 23.00 on any day, in a church hall, village hall, community hall, or other similar community premises, that is not licensed by a premises licence to sell alcohol, provided that (a) the audience does not exceed 500, and (b) the organiser gets consent for the performance from a person who is responsible for the premises.
 - a performance of amplified live music between 08.00 and 23.00 on any day, at the non-residential premises of (i) a local authority, or (ii) a school, or (iii) a hospital, provided that (a) the audience does not exceed 500, and (b) the organiser gets consent for the performance on the relevant premises from: (i) the local authority concerned, or (ii) the school or (iii) the health care provider for the hospital.
 - Recorded Music: no licence permission is required for:
 - any playing of recorded music between 08.00 and 23.00 on any day on premises authorised to sell alcohol for consumption on those premises, provided that the audience does not exceed 500.
 - any playing of recorded music between 08.00 and 23.00 on any day, in a church hall, village hall, community hall, or other similar community premises, that is not licensed by a premises licence to sell alcohol, provided that (a) the audience does not exceed 500, and (b) the organiser gets consent for the performance from a person who is responsible for the premises.
 - any playing of recorded music between 08.00 and 23.00 on any day, at the non-residential premises of (i) a local authority, or (ii) a school, or (iii) a hospital, provided that (a) the audience does not exceed 500, and (b) the organiser gets consent for the performance on the relevant premises from: (i) the local authority concerned, or (ii) the school proprietor or (iii) the health care provider for the hospital.
 - Dance: no licence is required for performances between 08.00 and 23.00 on any day, provided that the audience does not exceed 500. However, a performance which amounts to adult entertainment remains licensable.
 - Cross activity exemptions: no licence is required between 08.00 and 23.00 on any day, with no limit on audience size for:
 - any entertainment taking place on the premises of the local authority where the entertainment is provided by or on behalf of the local authority;
 - any entertainment taking place on the hospital premises of the health care provider where the entertainment is provided by or on behalf of the health care provider;
 - any entertainment taking place on the premises of the school where the entertainment is provided by or on behalf of the school proprietor; and
 - any entertainment (excluding films and a boxing or wrestling entertainment) taking place at a travelling circus, provided that (a) it takes place within a moveable structure that accommodates the audience, and (b) that the travelling circus has not been located on the same site for more than 28 consecutive days.
4. Where taking place in a building or other structure please tick as appropriate (indoors may include a tent).
 5. For example state type of activity to be authorised, if not already stated, and give relevant further details, for example (but not exclusively) whether or not music will be amplified or unamplified.
 6. For example (but not exclusively), where the activity will occur on additional days during the summer months.
 7. For example (but not exclusively), where you wish the activity to go on longer on a particular day e.g. Christmas Eve.

8. Please give timings in 24 hour clock (e.g. 16.00) and only give details for the days of the week when you intend the premises to be used for the activity.
9. If you wish people to be able to consume alcohol on the premises, please tick 'on the premises'. If you wish people to be able to purchase alcohol to consume away from the premises, please tick 'off the premises'. If you wish people to be able to do both, please tick 'both'.
10. Please give information about anything intended to occur at the premises or ancillary to the use of the premises which may give rise to concern in respect of children regardless of whether you intend children to have access to the premises, for example (but not exclusively) nudity or semi-nudity, films for restricted age groups or the presence of gaming machines.
11. Please list here steps you will take to promote all four licensing objectives together.
12. The application form must be signed.
13. An applicant's agent (for example solicitor) may sign the form on their behalf provided that they have actual authority to do so.
14. Where there is more than one applicant, each of the applicants or their respective agents must sign the application form.
15. This is the address which we shall use to correspond with you about this application.



- 1 MAR 2017

Sedbergh School
The Bursary
Sedbergh School
Malim Lodge
Sedbergh
Cumbria
LA10 5RY

South Lakeland District Council
South Lakeland House
Lowther Street
Kendal
Cumbria
LA9 4DQ

Tel: 01539 733333
www.southlakeland.gov.uk

Our Ref: PL(A)034745

Your Ref:

Date: 27 February 2017

Dear Sirs

**Licensing Act 2003 – Premises Licence PL(A)034745
Sedbergh School, Malim Lodge Sedbergh, Cumbria, LA10 5RY**

I enclose your premises licence issued under the Licensing Act 2003.

It is important to note that this licence does not override any planning restrictions on the operation of your premises. Should you wish to amend any such conditions, you should contact the appropriate planning authority for advice.

I also enclose a list of guidance notes setting out certain legal requirements for premises licence holders. You will note that one of the requirements is that a summary of the licence or a certified copy must be prominently displayed at the premises concerned.

Please do not hesitate to contact this office on 01539 733333 if you should have any queries or require further assistance.

Yours sincerely

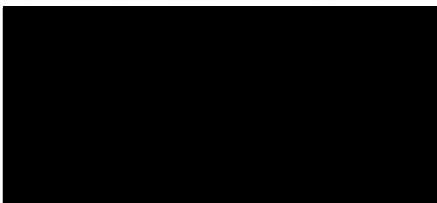

Licensing Assistant
Public Protection
Email: licensing@southlakeland.gov.uk
Enc. PLA, guidance notes

SOUTH LAKELAND DISTRICT COUNCIL

Public Protection Group
South Lakeland House
Lowther Street
Kendal
Cumbria LA9 4DQ



01539 733333
licensing@southlakeland.gov.uk

Licensing Act 2003

Premises Licence

Licence Valid From: 22 February 2017

PL(A)034745

Part 1 - Premises Details

POSTAL ADDRESS OF PREMISES, OR IF NONE, ORDNANCE SURVEY MAP REFERENCE OR DESCRIPTION

Sedbergh School, Malim Lodge, Sedbergh, Cumbria, LA10 5RY

WHERE THE LICENCE IS TIME LIMITED THE DATES

Not applicable

LICENSABLE ACTIVITIES AUTHORISED BY THE LICENCE

- a. Plays
- b. Films
- c. Indoor Sporting Events
- e. Live Music
- f. Recorded Music
- g. Performance of Dance
- h. Anything of a Similar Description to that Falling Within e, f or g
- Late Night Refreshment
- Supply of Alcohol

THE TIMES THE LICENCE AUTHORISES THE CARRYING OUT OF LICENSABLE ACTIVITIES

Activity (and Area if applicable)	Day	Start Time	End Time
a. Plays (Indoors and Outdoors)	Monday to Sunday	11:00	00:00
<u>Further Details:</u> Buildings and Grounds of : Lecture Theatre (ground and first floor), Queens Hall (ground and first floor), Powell Hall, Lupton House, Hart House, Carus House, Evans House, Powell House, Robertson House, School House, Sedgwick House & Winder House.			
b. Films (Indoors and Outdoors)	Monday to Sunday	11:00	00:00
<u>Further Details:</u> Buildings and Grounds of : Lecture Theatre (ground and first floor), Queens Hall (ground and first floor), Powell Hall, Lupton House, Hart House, Carus House, Evans House, Powell House, Robertson House, School House, Sedgwick House & Winder House.			
c. Indoor Sporting Events	Monday to Sunday	11:00	00:00
<u>Further Details:</u> Buildings and Grounds of : Lecture Theatre (ground and first floor), Queens Hall (ground and first floor), Powell Hall, Lupton House,			

SOUTH LAKELAND DISTRICT COUNCIL

Public Protection Group
South Lakeland House
Lowther Street
Kendal
Cumbria LA9 4DQ



01539 733333
licensing@southlakeland.gov.uk

Licensing Act 2003

Premises Licence

Licence Valid From: 22 February 2017

PL(A)034745

	Hart House, Carus House, Evans House, Powell House, Robertson House, School House, Sedgwick House & Winder House.
e. Live Music (Indoors and Outdoors)	Monday to Sunday 11:00 00:00 <u>Further Details:</u> Buildings and Grounds of : Lecture Theatre (ground and first floor), Queens Hall (ground and first floor), Powell Hall, Lupton House, Hart House, Carus House, Evans House, Powell House, Robertson House, School House, Sedgwick House & Winder House.
f. Recorded Music (Indoors and Outdoors)	Monday to Sunday 11:00 00:00 <u>Further Details:</u> Buildings and Grounds of : Lecture Theatre (ground and first floor), Queens Hall (ground and first floor), Powell Hall, Lupton House, Hart House, Carus House, Evans House, Powell House, Robertson House, School House, Sedgwick House & Winder House.
g. Performance of Dance (Indoors and Outdoors)	Monday to Sunday 11:00 00:00 <u>Further Details:</u> Buildings and Grounds of : Lecture Theatre (ground and first floor), Queens Hall (ground and first floor), Powell Hall, Lupton House, Hart House, Carus House, Evans House, Powell House, Robertson House, School House, Sedgwick House & Winder House.
h. Anything of a Similar Description to that Falling Within e, f or g (Indoors and Outdoors)	Monday to Sunday 11:00 00:00 <u>Further Details:</u> Buildings and Grounds of : Lecture Theatre (ground and first floor), Queens Hall (ground and first floor), Powell Hall, Lupton House, Hart House, Carus House, Evans House, Powell House, Robertson House, School House, Sedgwick House & Winder House.
Late Night Refreshment (Indoors and Outdoors)	Monday to Sunday 23:00 00:00 <u>Further Details:</u> Buildings and Grounds of : Lecture Theatre (ground and first floor), Queens Hall (ground and first floor), Powell Hall, Lupton House, Hart House, Carus House, Evans House, Powell House, Robertson House, School House, Sedgwick House & Winder House.
Supply of Alcohol	Monday to Sunday 11:00 00:00

SOUTH LAKELAND DISTRICT COUNCIL

Public Protection Group
South Lakeland House
Lowther Street
Kendal
Cumbria LA9 4DQ



01539 733333
licensing@southlakeland.gov.uk

Licensing Act 2003

Premises Licence

Licence Valid From: 22 February 2017

PL(A)034745

Further Details:

Buildings and Grounds of : Lecture Theatre (ground and first floor), Queens Hall (ground and first floor), Powell Hall, Lupton House, Hart House, Carus House, Evans House, Powell House, Robertson House, School House, Sedgwick House & Winder House.

THE OPENING HOURS OF THE PREMISES

Day	Start Time	End Time
Monday to Sunday	00:00	00:00

Non Standard Timings:

The premises licence shall permit members of the public to access the School for the purposes of licensable activities, only between the hours of 11am and 11pm daily. Buildings and Grounds of : Lecture Theatre (ground and first floor), Queens Hall (ground and first floor), Powell Hall, Lupton House, Hart House, Carus House, Evans House, Powell House, Robertson House, School House, Sedgwick House & Winder House.

WHERE THE LICENCE AUTHORISES SUPPLIES OF ALCOHOL WHETHER THESE ARE ON AND/OR OFF PREMISES

Alcohol On and Off the Premises

Part 2

NAME, (REGISTERED) ADDRESS, TELEPHONE NUMBER AND EMAIL (WHERE RELEVANT) OF HOLDER OF PREMISES LICENCE

Sedbergh School, Malim Lodge, Sedbergh, Cumbria, LA10 5RY (015396 21712)

REGISTERED NUMBER OF HOLDER, FOR EXAMPLE COMPANY NUMBER, CHARITY NUMBER (WHERE APPLICABLE)

NAME, ADDRESS AND TELEPHONE NUMBER OF DESIGNATED PREMISES SUPERVISOR WHERE THE PREMISES LICENCE AUTHORISES THE SUPPLY OF ALCOHOL

PERSONAL LICENCE NUMBER AND ISSUING AUTHORITY OF PERSONAL LICENCE HELD BY DESIGNATED PREMISES SUPERVISOR WHERE THE PREMISES LICENCE AUTHORISES FOR THE SUPPLY OF ALCOHOL

Licence Number [REDACTED] Issued By: Craven

ANNEXES

Annex 1

On and Off Licence - Mandatory Conditions

1. No supply of alcohol may be made under the premises licence –

SOUTH LAKELAND DISTRICT COUNCIL

Public Protection Group
South Lakeland House
Lowther Street
Kendal
Cumbria LA9 4DQ



01539 733333
licensing@southlakeland.gov.uk

Licensing Act 2003

Premises Licence

Licence Valid From: 22 February 2017

PL(A)034745

- a) At a time when there is no designated premises supervisor in respect of the premises licence, or;
 - b) At a time when the designated premises supervisor does not hold a personal licence, or his personal licence is suspended.
2. Every supply of alcohol under the premises licence must be made or authorised by a person who holds a personal licence.

Mandatory Licensing Conditions from 01 Oct 2014

1. (1) The responsible person must ensure that staff on relevant premises do not carry out, arrange or participate in any irresponsible promotions in relation to the premises.
(2) In this paragraph, an irresponsible promotion means any one or more of the following activities, or substantially similar activities, carried on for the purpose of encouraging the sale or supply of alcohol for consumption on the premises—
 - (a) games or other activities which require or encourage, or are designed to require or encourage, individuals to—
 - (i) drink a quantity of alcohol within a time limit (other than to drink alcohol sold or supplied on the premises before the cessation of the period in which the responsible person is authorised to sell or supply alcohol), or
 - (ii) drink as much alcohol as possible (whether within a time limit or otherwise);
 - (b) provision of unlimited or unspecified quantities of alcohol free or for a fixed or discounted fee to the public or to a group defined by a particular characteristic in a manner which carries a significant risk of undermining a licensing objective;
 - (c) provision of free or discounted alcohol or any other thing as a prize to encourage or reward the purchase and consumption of alcohol over a period of 24 hours or less in a manner which carries a significant risk of undermining a licensing objective;
 - (d) selling or supplying alcohol in association with promotional posters or flyers on, or in the vicinity of, the premises which can reasonably be considered to condone, encourage or glamorise anti-social behaviour or to refer to the effects of drunkenness in any favourable manner;
 - (e) dispensing alcohol directly by one person into the mouth of another (other than where that other person is unable to drink without assistance by reason of disability).
2. The responsible person must ensure that free potable water is provided on request to customers where it is reasonably available.
3. (1) The premises licence holder or club premises certificate holder must ensure that an age verification policy is adopted in respect of the premises in relation to the sale or supply of alcohol.
(2) The designated premises supervisor in relation to the premises licence must ensure that the supply

SOUTH LAKELAND DISTRICT COUNCIL

Public Protection Group
South Lakeland House
Lowther Street
Kendal
Cumbria LA9 4DQ



01539 733333
licensing@southlakeland.gov.uk

Licensing Act 2003

Premises Licence

Licence Valid From: 22 February 2017

PL(A)034745

of alcohol at the premises is carried on in accordance with the age verification policy.

- (3) The policy must require individuals who appear to the responsible person to be under 18 years of age (or such older age as may be specified in the policy) to produce on request, before being served alcohol, identification bearing their photograph, date of birth and either—

- (a) a holographic mark, or
- (b) an ultraviolet feature.

4. The responsible person must ensure that—

- (a) where any of the following alcoholic drinks is sold or supplied for consumption on the premises (other than alcoholic drinks sold or supplied having been made up in advance ready for sale or supply in a securely closed container) it is available to customers in the following measures—

- (i) beer or cider: ½ pint;
- (ii) gin, rum, vodka or whisky: 25 ml or 35 ml; and
- (iii) still wine in a glass: 125 ml;

- (b) these measures are displayed in a menu, price list or other printed material which is available to customers on the premises; and

- (c) where a customer does not in relation to a sale of alcohol specify the quantity of alcohol to be sold, the customer is made aware that these measures are available.”

Mandatory Conditions Order 2014

1. A relevant person shall ensure that no alcohol is sold or supplied for consumption on or off the premises for a price which is less than the permitted price.

2. For the purposes of the condition set out in paragraph 1—

- (a) “duty” is to be construed in accordance with the Alcoholic Liquor Duties Act 1979(1);

- (b) “permitted price” is the price found by applying the formula—

$$P = D + (D \times V)$$

where—

- (i) P is the permitted price,
- (ii) D is the amount of duty chargeable in relation to the alcohol as if the duty were charged on the date of the sale or supply of the alcohol, and
- (iii) V is the rate of value added tax chargeable in relation to the alcohol as if the value added tax were charged on the date of the sale or supply of the alcohol;

- (c) “relevant person” means, in relation to premises in respect of which there is in force a premises licence—

- (i) the holder of the premises licence,
- (ii) the designated premises supervisor (if any) in respect of such a licence, or
- (iii) the personal licence holder who makes or authorises a supply of alcohol under such a licence;

SOUTH LAKELAND DISTRICT COUNCIL



Public Protection Group
South Lakeland House
Lowther Street
Kendal
Cumbria LA9 4DQ

01539 733333
licensing@southlakeland.gov.uk

Licensing Act 2003

Premises Licence

Licence Valid From: 22 February 2017

PL(A)034745

(d) "relevant person" means, in relation to premises in respect of which there is in force a club premises certificate, any member or officer of the club present on the premises in a capacity which enables the member or officer to prevent the supply in question; and

(e) "value added tax" means value added tax charged in accordance with the Value Added Tax Act 1994

3. Where the permitted price given by Paragraph (b) of paragraph 2 would (apart from this paragraph) not be a whole number of pennies, the price given by that sub-paragraph shall be taken to be the price actually given by that sub-paragraph rounded up to the nearest penny.

4. (1) Sub-paragraph (2) applies where the permitted price given by Paragraph (b) of paragraph 2 on a day ("the first day") would be different from the permitted price on the next day ("the second day") as a result of a change to the rate of duty or value added tax.
- (2) The permitted price which would apply on the first day applies to sales or supplies of alcohol which take place before the expiry of the period of 14 days beginning on the second day.

Films:

1. Where the film classification body is specified in the licence, unless (2) applies, admission of children must be restricted in accordance with any recommendations made by that body.
2. Where -
- a) The film classification body is not specified in the licence, or; b) the relevant licensing authority has notified the holder of the licence that this condition is applied to the film in question.

Admission of children must be restricted in accordance with any recommendation made by that licensing authority.

Annex 2: Conditions Consistent with the Operating Schedule

The Prevention of Crime and Disorder

1. All licensable events taking place at the School and its grounds shall be approved in advance by the Head or Bursar, as appropriate.
2. Members of the public accessing the School and its grounds for the purpose of licensable activities shall be permitted to do so as guests of the School, by invitation or by ticket only.
3. Open containers of alcohol shall not be taken beyond the curtilage of the School and its grounds.

Public Safety

1. The safe capacity of any part of the School and its grounds used for licensable activities shall be risk assessed (in conjunction with the Fire Authority where appropriate.)

SOUTH LAKELAND DISTRICT COUNCIL

Public Protection Group
South Lakeland House
Lowther Street
Kendal
Cumbria LA9 4DQ



01539 733333
licensing@southlakeland.gov.uk

Licensing Act 2003

Premises Licence

Licence Valid From: 22 February 2017

PL(A)034745

2. Regular safety checks shall be carried out by staff.
3. Management shall liaise with the Fire Authority as necessary to ensure compliance with all necessary fire regulations.
4. The School shall maintain an incident log and public liability insurance.

The Prevention of Public Nuisance

1. Noise from amplified music or voices shall not be such as to cause a noise nuisance to occupants of nearby premises.
2. Notices will be positioned at the exits to the School and its buildings requesting guests to leave in a quiet manner.
3. The telephone number of the Designated Premises Supervisor and Operations Manager shall be made available to residents upon request.

The Protection of Children From Harm

1. All staff shall receive training on the law relating to the prohibition of the sale of alcohol to children
2. A "Challenge 21" Policy shall be implemented and appropriate identification sought from any person who appears to be under the age of 21 who wishes to purchase alcohol. The only acceptable forms of ID are photographic driving licences, passports, HM forces warrant cards, EU/EEA national ID card or similar document or a form of identification with the "PASS" hologram.
3. Staff training will include the Challenge 21 Policy and its operation. In particular, staff shall be trained to take such action as is necessary to prevent the sale of alcohol to persons over the age of 18 where those customers are engaged in the distribution of alcohol to persons under the age of 18. The training must be given to a new member of staff before they commence employment and all staff must receive refresher training every 6 months.

SOUTH LAKELAND DISTRICT COUNCIL



Public Protection Group
South Lakeland House
Lowther Street
Kendal
Cumbria LA9 4DQ

01539 733333
licensing@southlakeland.gov.uk

Licensing Act 2003

Premises Licence Summary

Licence Valid From: 22 February 2017

PL(A)034745

Premises Details

POSTAL ADDRESS OF PREMISES, OR IF NONE, ORDNANCE SURVEY MAP REFERENCE OR DESCRIPTION

Sedbergh School, Malim Lodge, Sedbergh, Cumbria, LA10 5RY

WHERE THE LICENCE IS TIME LIMITED THE DATES

Not applicable

LICENSABLE ACTIVITIES AUTHORISED BY THE LICENCE

- a. Plays
- b. Films
- c. Indoor Sporting Events
- e. Live Music
- f. Recorded Music
- g. Performance of Dance
- h. Anything of a Similar Description to that Falling Within e, f or g
- Late Night Refreshment
- Supply of Alcohol

THE TIMES THE LICENCE AUTHORISES THE CARRYING OUT OF LICENSABLE ACTIVITIES

Activity (and Area if applicable)	Day	Start Time	End Time
a. Plays (Indoors and Outdoors)	Monday to Sunday	11:00	00:00
<u>Further Details:</u> Buildings and Grounds of : Lecture Theatre (ground and first floor), Queens Hall (ground and first floor), Powell Hall, Lupton House, Hart House, Carus House, Evans House, Powell House, Robertson House, School House, Sedgwick House & Winder House.			
b. Films (Indoors and Outdoors)	Monday to Sunday	11:00	00:00
<u>Further Details:</u> Buildings and Grounds of : Lecture Theatre (ground and first floor), Queens Hall (ground and first floor), Powell Hall, Lupton House, Hart House, Carus House, Evans House, Powell House, Robertson House, School House, Sedgwick House & Winder House.			
c. Indoor Sporting Events	Monday to Sunday	11:00	00:00
<u>Further Details:</u> Buildings and Grounds of : Lecture Theatre (ground and first floor), Queens Hall (ground and first floor), Powell Hall, Lupton House, Hart House, Carus House, Evans House, Powell House, Robertson House, School House, Sedgwick House & Winder			

SOUTH LAKELAND DISTRICT COUNCIL

Public Protection Group
South Lakeland House
Lowther Street
Kendal
Cumbria LA9 4DQ



01539 733333
licensing@southlakeland.gov.uk

Licensing Act 2003

Premises Licence Summary

PL(A)034745

Licence Valid From: 22 February 2017

	House.
e. Live Music (Indoors and Outdoors)	Monday to Sunday 11:00 00:00 <u>Further Details:</u> Buildings and Grounds of : Lecture Theatre (ground and first floor), Queens Hall (ground and first floor), Powell Hall, Lupton House, Hart House, Carus House, Evans House, Powell House, Robertson House, School House, Sedgwick House & Winder House.
f. Recorded Music (Indoors and Outdoors)	Monday to Sunday 11:00 00:00 <u>Further Details:</u> Buildings and Grounds of : Lecture Theatre (ground and first floor), Queens Hall (ground and first floor), Powell Hall, Lupton House, Hart House, Carus House, Evans House, Powell House, Robertson House, School House, Sedgwick House & Winder House.
g. Performance of Dance (Indoors and Outdoors)	Monday to Sunday 11:00 00:00 <u>Further Details:</u> Buildings and Grounds of : Lecture Theatre (ground and first floor), Queens Hall (ground and first floor), Powell Hall, Lupton House, Hart House, Carus House, Evans House, Powell House, Robertson House, School House, Sedgwick House & Winder House.
h. Anything of a Similar Description to that Falling Within e, f or g (Indoors and Outdoors)	Monday to Sunday 11:00 00:00 <u>Further Details:</u> Buildings and Grounds of : Lecture Theatre (ground and first floor), Queens Hall (ground and first floor), Powell Hall, Lupton House, Hart House, Carus House, Evans House, Powell House, Robertson House, School House, Sedgwick House & Winder House.
Late Night Refreshment (Indoors and Outdoors)	Monday to Sunday 23:00 00:00 <u>Further Details:</u> Buildings and Grounds of : Lecture Theatre (ground and first floor), Queens Hall (ground and first floor), Powell Hall, Lupton House, Hart House, Carus House, Evans House, Powell House, Robertson House, School House, Sedgwick House & Winder House.
Supply of Alcohol	Monday to Sunday 11:00 00:00 <u>Further Details:</u> Buildings and Grounds of : Lecture Theatre (ground and first floor),

SOUTH LAKELAND DISTRICT COUNCIL



Public Protection Group
South Lakeland House
Lowther Street
Kendal
Cumbria LA9 4DQ

01539 733333
licensing@southlakeland.gov.uk

Licensing Act 2003

Premises Licence Summary

PL(A)034745

Licence Valid From: 22 February 2017

Queens Hall (ground and first floor), Powell Hall, Lupton House, Hart House, Carus House, Evans House, Powell House, Robertson House, School House, Sedgwick House & Winder House.

THE OPENING HOURS OF THE PREMISES

Day	Start Time	End Time
Monday to Sunday	00:00	00:00

Non Standard Timings:

The premises licence shall permit members of the public to access the School for the purposes of licensable activities, only between the hours of 11am and 11pm daily. Buildings and Grounds of : Lecture Theatre (ground and first floor), Queens Hall (ground and first floor), Powell Hall, Lupton House, Hart House, Carus House, Evans House, Powell House, Robertson House, School House, Sedgwick House & Winder House.

WHERE THE LICENCE AUTHORISES SUPPLIES OF ALCOHOL WHETHER THESE ARE ON AND/OR OFF PREMISES

Alcohol On and Off the Premises

NAME AND (REGISTERED) ADDRESS OF HOLDER OF PREMISES LICENCE

Sedbergh School, Malim Lodge, Sedbergh, Cumbria, LA10 5RY (015396 21712)

REGISTERED NUMBER OF HOLDER, FOR EXAMPLE COMPANY NUMBER, CHARITY NUMBER (WHERE APPLICABLE)

NAME OF DESIGNATED PREMISES SUPERVISOR WHERE THE PREMISES LICENCE AUTHORISES THE SUPPLY OF ALCOHOL

STATE WHETHER ACCESS TO THE PREMISES BY CHILDREN IS RESTRICTED OR PROHIBITED



- 1 MAR 2017

Sedbergh School
The Bursary
Sedbergh School
Malim Lodge
Sedbergh
Cumbria
LA10 5RY

South Lakeland District Council
South Lakeland House
Lowther Street
Kendal
Cumbria
LA9 4DQ

Tel: 01539 733333
www.southlakeland.gov.uk

Our Ref: PL(A)034745

Your Ref:

Date: 27 February 2017

Dear Sirs

**Licensing Act 2003 – Premises Licence PL(A)034745
Sedbergh School, Malim Lodge Sedbergh, Cumbria, LA10 5RY**

I enclose your premises licence issued under the Licensing Act 2003.

It is important to note that this licence does not override any planning restrictions on the operation of your premises. Should you wish to amend any such conditions, you should contact the appropriate planning authority for advice.

I also enclose a list of guidance notes setting out certain legal requirements for premises licence holders. You will note that one of the requirements is that a summary of the licence or a certified copy must be prominently displayed at the premises concerned.

Please do not hesitate to contact this office on 01539 733333 if you should have any queries or require further assistance.

Yours sincerely

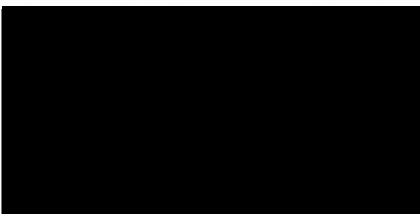

Public Protection
Email: licensing@southlakeland.gov.uk
Enc. PLA, guidance notes

SOUTH LAKELAND DISTRICT COUNCIL

Public Protection Group
South Lakeland House
Lowther Street
Kendal
Cumbria LA9 4DQ



01539 733333
licensing@southlakeland.gov.uk

Licensing Act 2003

Premises Licence

Licence Valid From: 22 February 2017

PL(A)034745

Part 1 - Premises Details

POSTAL ADDRESS OF PREMISES, OR IF NONE, ORDNANCE SURVEY MAP REFERENCE OR DESCRIPTION

Sedbergh School, Malim Lodge, Sedbergh, Cumbria, LA10 5RY

WHERE THE LICENCE IS TIME LIMITED THE DATES

Not applicable

LICENSABLE ACTIVITIES AUTHORISED BY THE LICENCE

- a. Plays
- b. Films
- c. Indoor Sporting Events
- e. Live Music
- f. Recorded Music
- g. Performance of Dance
- h. Anything of a Similar Description to that Falling Within e, f or g
- Late Night Refreshment
- Supply of Alcohol

THE TIMES THE LICENCE AUTHORISES THE CARRYING OUT OF LICENSABLE ACTIVITIES

Activity (and Area if applicable)	Day	Start Time	End Time
a. Plays (Indoors and Outdoors)	Monday to Sunday	11:00	00:00
<u>Further Details:</u> Buildings and Grounds of : Lecture Theatre (ground and first floor), Queens Hall (ground and first floor), Powell Hall, Lupton House, Hart House, Carus House, Evans House, Powell House, Robertson House, School House, Sedgwick House & Winder House.			
b. Films (Indoors and Outdoors)	Monday to Sunday	11:00	00:00
<u>Further Details:</u> Buildings and Grounds of : Lecture Theatre (ground and first floor), Queens Hall (ground and first floor), Powell Hall, Lupton House, Hart House, Carus House, Evans House, Powell House, Robertson House, School House, Sedgwick House & Winder House.			
c. Indoor Sporting Events	Monday to Sunday	11:00	00:00
<u>Further Details:</u> Buildings and Grounds of : Lecture Theatre (ground and first floor), Queens Hall (ground and first floor), Powell Hall, Lupton House,			

SOUTH LAKELAND DISTRICT COUNCIL

Public Protection Group
South Lakeland House
Lowther Street
Kendal
Cumbria LA9 4DQ



01539 733333
licensing@southlakeland.gov.uk

Licensing Act 2003

Premises Licence

Licence Valid From: 22 February 2017

PL(A)034745

	Hart House, Carus House, Evans House, Powell House, Robertson House, School House, Sedgwick House & Winder House.
e. Live Music (Indoors and Outdoors)	Monday to Sunday 11:00 00:00 <u>Further Details:</u> Buildings and Grounds of : Lecture Theatre (ground and first floor), Queens Hall (ground and first floor), Powell Hall, Lupton House, Hart House, Carus House, Evans House, Powell House, Robertson House, School House, Sedgwick House & Winder House.
f. Recorded Music (Indoors and Outdoors)	Monday to Sunday 11:00 00:00 <u>Further Details:</u> Buildings and Grounds of : Lecture Theatre (ground and first floor), Queens Hall (ground and first floor), Powell Hall, Lupton House, Hart House, Carus House, Evans House, Powell House, Robertson House, School House, Sedgwick House & Winder House.
g. Performance of Dance (Indoors and Outdoors)	Monday to Sunday 11:00 00:00 <u>Further Details:</u> Buildings and Grounds of : Lecture Theatre (ground and first floor), Queens Hall (ground and first floor), Powell Hall, Lupton House, Hart House, Carus House, Evans House, Powell House, Robertson House, School House, Sedgwick House & Winder House.
h. Anything of a Similar Description to that Falling Within e, f or g (Indoors and Outdoors)	Monday to Sunday 11:00 00:00 <u>Further Details:</u> Buildings and Grounds of : Lecture Theatre (ground and first floor), Queens Hall (ground and first floor), Powell Hall, Lupton House, Hart House, Carus House, Evans House, Powell House, Robertson House, School House, Sedgwick House & Winder House.
Late Night Refreshment (Indoors and Outdoors)	Monday to Sunday 23:00 00:00 <u>Further Details:</u> Buildings and Grounds of : Lecture Theatre (ground and first floor), Queens Hall (ground and first floor), Powell Hall, Lupton House, Hart House, Carus House, Evans House, Powell House, Robertson House, School House, Sedgwick House & Winder House.
Supply of Alcohol	Monday to Sunday 11:00 00:00

SOUTH LAKELAND DISTRICT COUNCIL

Public Protection Group
South Lakeland House
Lowther Street
Kendal
Cumbria LA9 4DQ



01539 733333
licensing@southlakeland.gov.uk

Licensing Act 2003

Premises Licence

Licence Valid From: 22 February 2017

PL(A)034745

Further Details:

Buildings and Grounds of : Lecture Theatre (ground and first floor), Queens Hall (ground and first floor), Powell Hall, Lupton House, Hart House, Carus House, Evans House, Powell House, Robertson House, School House, Sedgwick House & Winder House.

THE OPENING HOURS OF THE PREMISES

Day	Start Time	End Time
Monday to Sunday	00:00	00:00

Non Standard Timings:

The premises licence shall permit members of the public to access the School for the purposes of licensable activities, only between the hours of 11am and 11pm daily. Buildings and Grounds of : Lecture Theatre (ground and first floor), Queens Hall (ground and first floor), Powell Hall, Lupton House, Hart House, Carus House, Evans House, Powell House, Robertson House, School House, Sedgwick House & Winder House.

WHERE THE LICENCE AUTHORISES SUPPLIES OF ALCOHOL WHETHER THESE ARE ON AND/OR OFF PREMISES

Alcohol On and Off the Premises

Part 2

NAME, (REGISTERED) ADDRESS, TELEPHONE NUMBER AND EMAIL (WHERE RELEVANT) OF HOLDER OF PREMISES LICENCE

Sedbergh School, Malim Lodge, Sedbergh, Cumbria, LA10 5RY (015396 21712)

REGISTERED NUMBER OF HOLDER, FOR EXAMPLE COMPANY NUMBER, CHARITY NUMBER (WHERE APPLICABLE)

NAME, ADDRESS AND TELEPHONE NUMBER OF DESIGNATED PREMISES SUPERVISOR WHERE THE PREMISES LICENCE AUTHORISES THE SUPPLY OF ALCOHOL

PERSONAL LICENCE NUMBER AND ISSUING AUTHORITY OF PERSONAL LICENCE HELD BY DESIGNATED PREMISES SUPERVISOR WHERE THE PREMISES LICENCE AUTHORISES FOR THE SUPPLY OF ALCOHOL

Licence Number: [REDACTED] Issued By: Craven

ANNEXES

Annex 1

On and Off Licence - Mandatory Conditions

1. No supply of alcohol may be made under the premises licence –

SOUTH LAKELAND DISTRICT COUNCIL

Public Protection Group
South Lakeland House
Lowther Street
Kendal
Cumbria LA9 4DQ



01539 733333
licensing@southlakeland.gov.uk

Licensing Act 2003

Premises Licence

Licence Valid From: 22 February 2017

PL(A)034745

- a) At a time when there is no designated premises supervisor in respect of the premises licence, or;
 - b) At a time when the designated premises supervisor does not hold a personal licence, or his personal licence is suspended.
2. Every supply of alcohol under the premises licence must be made or authorised by a person who holds a personal licence.

Mandatory Licensing Conditions from 01 Oct 2014

1. (1) The responsible person must ensure that staff on relevant premises do not carry out, arrange or participate in any irresponsible promotions in relation to the premises.
(2) In this paragraph, an irresponsible promotion means any one or more of the following activities, or substantially similar activities, carried on for the purpose of encouraging the sale or supply of alcohol for consumption on the premises—
 - (a) games or other activities which require or encourage, or are designed to require or encourage, individuals to—
 - (i) drink a quantity of alcohol within a time limit (other than to drink alcohol sold or supplied on the premises before the cessation of the period in which the responsible person is authorised to sell or supply alcohol), or
 - (ii) drink as much alcohol as possible (whether within a time limit or otherwise);
 - (b) provision of unlimited or unspecified quantities of alcohol free or for a fixed or discounted fee to the public or to a group defined by a particular characteristic in a manner which carries a significant risk of undermining a licensing objective;
 - (c) provision of free or discounted alcohol or any other thing as a prize to encourage or reward the purchase and consumption of alcohol over a period of 24 hours or less in a manner which carries a significant risk of undermining a licensing objective;
 - (d) selling or supplying alcohol in association with promotional posters or flyers on, or in the vicinity of, the premises which can reasonably be considered to condone, encourage or glamorise anti-social behaviour or to refer to the effects of drunkenness in any favourable manner;
 - (e) dispensing alcohol directly by one person into the mouth of another (other than where that other person is unable to drink without assistance by reason of disability).
2. The responsible person must ensure that free potable water is provided on request to customers where it is reasonably available.
3. (1) The premises licence holder or club premises certificate holder must ensure that an age verification policy is adopted in respect of the premises in relation to the sale or supply of alcohol.
(2) The designated premises supervisor in relation to the premises licence must ensure that the supply

SOUTH LAKELAND DISTRICT COUNCIL

Public Protection Group
South Lakeland House
Lowther Street
Kendal
Cumbria LA9 4DQ



01539 733333
licensing@southlakeland.gov.uk

Licensing Act 2003

Premises Licence

Licence Valid From: 22 February 2017

PL(A)034745

of alcohol at the premises is carried on in accordance with the age verification policy.

- (3) The policy must require individuals who appear to the responsible person to be under 18 years of age (or such older age as may be specified in the policy) to produce on request, before being served alcohol, identification bearing their photograph, date of birth and either—

- (a) a holographic mark, or
- (b) an ultraviolet feature.

4. The responsible person must ensure that—

- (a) where any of the following alcoholic drinks is sold or supplied for consumption on the premises (other than alcoholic drinks sold or supplied having been made up in advance ready for sale or supply in a securely closed container) it is available to customers in the following measures—

- (i) beer or cider: ½ pint;
- (ii) gin, rum, vodka or whisky: 25 ml or 35 ml; and
- (iii) still wine in a glass: 125 ml;

- (b) these measures are displayed in a menu, price list or other printed material which is available to customers on the premises; and

- (c) where a customer does not in relation to a sale of alcohol specify the quantity of alcohol to be sold, the customer is made aware that these measures are available.”

Mandatory Conditions Order 2014

1. A relevant person shall ensure that no alcohol is sold or supplied for consumption on or off the premises for a price which is less than the permitted price.

2. For the purposes of the condition set out in paragraph 1—

- (a) “duty” is to be construed in accordance with the Alcoholic Liquor Duties Act 1979(1);

- (b) “permitted price” is the price found by applying the formula—

$$P = D + (D \times V)$$

where—

- (i) P is the permitted price,
- (ii) D is the amount of duty chargeable in relation to the alcohol as if the duty were charged on the date of the sale or supply of the alcohol, and
- (iii) V is the rate of value added tax chargeable in relation to the alcohol as if the value added tax were charged on the date of the sale or supply of the alcohol;

- (c) “relevant person” means, in relation to premises in respect of which there is in force a premises licence—

- (i) the holder of the premises licence,
- (ii) the designated premises supervisor (if any) in respect of such a licence, or
- (iii) the personal licence holder who makes or authorises a supply of alcohol under such a licence;

SOUTH LAKELAND DISTRICT COUNCIL



Public Protection Group
South Lakeland House
Lowther Street
Kendal
Cumbria LA9 4DQ

01539 733333
licensing@southlakeland.gov.uk

Licensing Act 2003

Premises Licence

Licence Valid From: 22 February 2017

PL(A)034745

(d) "relevant person" means, in relation to premises in respect of which there is in force a club premises certificate, any member or officer of the club present on the premises in a capacity which enables the member or officer to prevent the supply in question; and

(e) "value added tax" means value added tax charged in accordance with the Value Added Tax Act 1994

3. Where the permitted price given by Paragraph (b) of paragraph 2 would (apart from this paragraph) not be a whole number of pennies, the price given by that sub-paragraph shall be taken to be the price actually given by that sub-paragraph rounded up to the nearest penny.

4. (1) Sub-paragraph (2) applies where the permitted price given by Paragraph (b) of paragraph 2 on a day ("the first day") would be different from the permitted price on the next day ("the second day") as a result of a change to the rate of duty or value added tax.
(2) The permitted price which would apply on the first day applies to sales or supplies of alcohol which take place before the expiry of the period of 14 days beginning on the second day.

Films:

1. Where the film classification body is specified in the licence, unless (2) applies, admission of children must be restricted in accordance with any recommendations made by that body.

2. Where -

a) The film classification body is not specified in the licence, or; b) the relevant licensing authority has notified the holder of the licence that this condition is applied to the film in question.

Admission of children must be restricted in accordance with any recommendation made by that licensing authority.

Annex 2: Conditions Consistent with the Operating Schedule

The Prevention of Crime and Disorder

1. All licensable events taking place at the School and its grounds shall be approved in advance by the Head or Bursar, as appropriate.
2. Members of the public accessing the School and its grounds for the purpose of licensable activities shall be permitted to do so as guests of the School, by invitation or by ticket only.
3. Open containers of alcohol shall not be taken beyond the curtilage of the School and its grounds.

Public Safety

1. The safe capacity of any part of the School and its grounds used for licensable activities shall be risk assessed (in conjunction with the Fire Authority where appropriate.)

SOUTH LAKELAND DISTRICT COUNCIL

Public Protection Group
South Lakeland House
Lowther Street
Kendal
Cumbria LA9 4DQ



01539 733333
licensing@southlakeland.gov.uk

Licensing Act 2003

Premises Licence

Licence Valid From: 22 February 2017

PL(A)034745

2. Regular safety checks shall be carried out by staff.
3. Management shall liaise with the Fire Authority as necessary to ensure compliance with all necessary fire regulations.
4. The School shall maintain an incident log and public liability insurance.

The Prevention of Public Nuisance

1. Noise from amplified music or voices shall not be such as to cause a noise nuisance to occupants of nearby premises.
2. Notices will be positioned at the exits to the School and its buildings requesting guests to leave in a quiet manner.
3. The telephone number of the Designated Premises Supervisor and Operations Manager shall be made available to residents upon request.

The Protection of Children From Harm

1. All staff shall receive training on the law relating to the prohibition of the sale of alcohol to children
2. A "Challenge 21" Policy shall be implemented and appropriate identification sought from any person who appears to be under the age of 21 who wishes to purchase alcohol. The only acceptable forms of ID are photographic driving licences, passports, HM forces warrant cards, EU/EEA national ID card or similar document or a form of identification with the "PASS" hologram.
3. Staff training will include the Challenge 21 Policy and its operation. In particular, staff shall be trained to take such action as is necessary to prevent the sale of alcohol to persons over the age of 18 where those customers are engaged in the distribution of alcohol to persons under the age of 18. The training must be given to a new member of staff before they commence employment and all staff must receive refresher training every 6 months.

SOUTH LAKELAND DISTRICT COUNCIL



Public Protection Group
South Lakeland House
Lowther Street
Kendal
Cumbria LA9 4DQ

01539 733333
licensing@southlakeland.gov.uk

Licensing Act 2003

Premises Licence Summary

PL(A)034745

Licence Valid From: 22 February 2017

Premises Details

POSTAL ADDRESS OF PREMISES, OR IF NONE, ORDNANCE SURVEY MAP REFERENCE OR DESCRIPTION

Sedbergh School, Malim Lodge, Sedbergh, Cumbria, LA10 5RY

WHERE THE LICENCE IS TIME LIMITED THE DATES

Not applicable

LICENSABLE ACTIVITIES AUTHORISED BY THE LICENCE

- a. Plays
- b. Films
- c. Indoor Sporting Events
- e. Live Music
- f. Recorded Music
- g. Performance of Dance
- h. Anything of a Similar Description to that Falling Within e, f or g
- Late Night Refreshment
- Supply of Alcohol

THE TIMES THE LICENCE AUTHORISES THE CARRYING OUT OF LICENSABLE ACTIVITIES

Activity (and Area if applicable)	Day	Start Time	End Time
a. Plays (Indoors and Outdoors)	Monday to Sunday	11:00	00:00
<u>Further Details:</u> Buildings and Grounds of : Lecture Theatre (ground and first floor), Queens Hall (ground and first floor), Powell Hall, Lupton House, Hart House, Carus House, Evans House, Powell House, Robertson House, School House, Sedgwick House & Winder House.			
b. Films (Indoors and Outdoors)	Monday to Sunday	11:00	00:00
<u>Further Details:</u> Buildings and Grounds of : Lecture Theatre (ground and first floor), Queens Hall (ground and first floor), Powell Hall, Lupton House, Hart House, Carus House, Evans House, Powell House, Robertson House, School House, Sedgwick House & Winder House.			
c. Indoor Sporting Events	Monday to Sunday	11:00	00:00
<u>Further Details:</u> Buildings and Grounds of : Lecture Theatre (ground and first floor), Queens Hall (ground and first floor), Powell Hall, Lupton House, Hart House, Carus House, Evans House, Powell House, Robertson House, School House, Sedgwick House & Winder			

SOUTH LAKELAND DISTRICT COUNCIL

Public Protection Group
South Lakeland House
Lowther Street
Kendal
Cumbria LA9 4DQ



01539 733333
licensing@southlakeland.gov.uk

Licensing Act 2003

Premises Licence Summary

PL(A)034745

Licence Valid From: 22 February 2017

	House.
e. Live Music (Indoors and Outdoors)	Monday to Sunday 11:00 00:00 <u>Further Details:</u> Buildings and Grounds of : Lecture Theatre (ground and first floor), Queens Hall (ground and first floor), Powell Hall, Lupton House, Hart House, Carus House, Evans House, Powell House, Robertson House, School House, Sedgwick House & Winder House.
f. Recorded Music (Indoors and Outdoors)	Monday to Sunday 11:00 00:00 <u>Further Details:</u> Buildings and Grounds of : Lecture Theatre (ground and first floor), Queens Hall (ground and first floor), Powell Hall, Lupton House, Hart House, Carus House, Evans House, Powell House, Robertson House, School House, Sedgwick House & Winder House.
g. Performance of Dance (Indoors and Outdoors)	Monday to Sunday 11:00 00:00 <u>Further Details:</u> Buildings and Grounds of : Lecture Theatre (ground and first floor), Queens Hall (ground and first floor), Powell Hall, Lupton House, Hart House, Carus House, Evans House, Powell House, Robertson House, School House, Sedgwick House & Winder House.
h. Anything of a Similar Description to that Falling Within e, f or g (Indoors and Outdoors)	Monday to Sunday 11:00 00:00 <u>Further Details:</u> Buildings and Grounds of : Lecture Theatre (ground and first floor), Queens Hall (ground and first floor), Powell Hall, Lupton House, Hart House, Carus House, Evans House, Powell House, Robertson House, School House, Sedgwick House & Winder House.
Late Night Refreshment (Indoors and Outdoors)	Monday to Sunday 23:00 00:00 <u>Further Details:</u> Buildings and Grounds of : Lecture Theatre (ground and first floor), Queens Hall (ground and first floor), Powell Hall, Lupton House, Hart House, Carus House, Evans House, Powell House, Robertson House, School House, Sedgwick House & Winder House.
Supply of Alcohol	Monday to Sunday 11:00 00:00 <u>Further Details:</u> Buildings and Grounds of : Lecture Theatre (ground and first floor),

SOUTH LAKELAND DISTRICT COUNCIL

Public Protection Group
South Lakeland House
Lowther Street
Kendal
Cumbria LA9 4DQ



01539 733333
licensing@southlakeland.gov.uk

Licensing Act 2003

Premises Licence Summary

PL(A)034745

Licence Valid From: 22 February 2017

Queens Hall (ground and first floor), Powell Hall, Lupton House, Hart House, Carus House, Evans House, Powell House, Robertson House, School House, Sedgwick House & Winder House.

THE OPENING HOURS OF THE PREMISES

Day	Start Time	End Time
Monday to Sunday	00:00	00:00

Non Standard Timings:

The premises licence shall permit members of the public to access the School for the purposes of licensable activities, only between the hours of 11am and 11pm daily. Buildings and Grounds of : Lecture Theatre (ground and first floor), Queens Hall (ground and first floor), Powell Hall, Lupton House, Hart House, Carus House, Evans House, Powell House, Robertson House, School House, Sedgwick House & Winder House.

WHERE THE LICENCE AUTHORISES SUPPLIES OF ALCOHOL WHETHER THESE ARE ON AND/OR OFF PREMISES

Alcohol On and Off the Premises

NAME AND (REGISTERED) ADDRESS OF HOLDER OF PREMISES LICENCE

Sedbergh School, Malim Lodge, Sedbergh, Cumbria, LA10 5RY (015396 21712)

REGISTERED NUMBER OF HOLDER, FOR EXAMPLE COMPANY NUMBER, CHARITY NUMBER (WHERE APPLICABLE)

NAME OF DESIGNATED PREMISES SUPERVISOR WHERE THE PREMISES LICENCE AUTHORISES THE SUPPLY OF ALCOHOL

STATE WHETHER ACCESS TO THE PREMISES BY CHILDREN IS RESTRICTED OR PROHIBITED

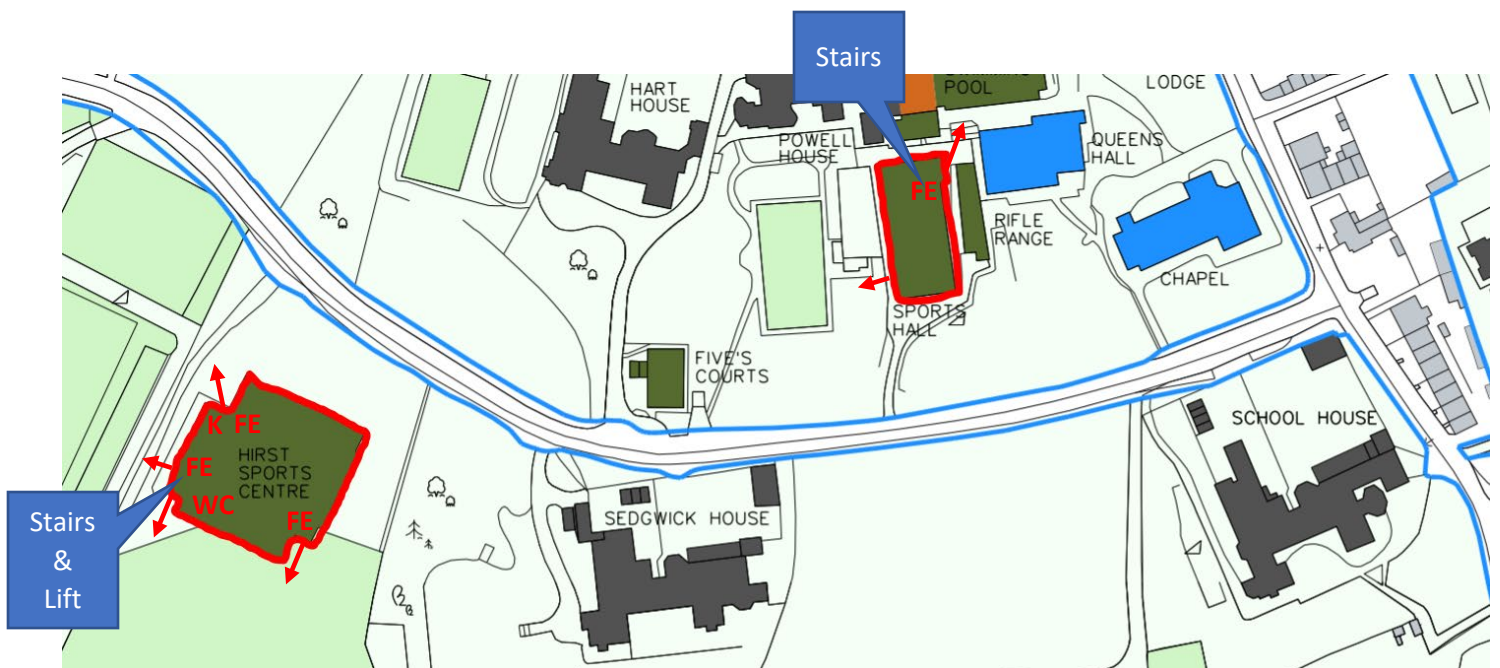
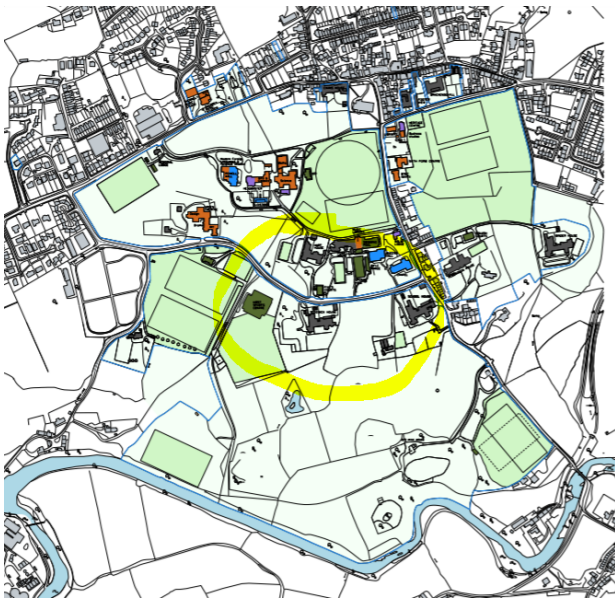

Legend:

WC	Toilet facilities
→	Emergency exit route
K	Kitchenette
FE	Fire Extinguisher

1. Do not scale from this drawing. Use dimension lines only.
2. All structural dimensions, levels, walling profiles and all hardware to be provided by the Contractor, with any dimensions noted on drawings and plans.
3. All work to be carried out to the satisfaction of the Local Authority and in accordance with Building Regulations, Safety Standards, CDM Regulations, Control of Asbestos, Fire & Smoke, Environmental considerations, equality, diversity and equality of access.
4. References to Local Authority are abbreviations used in Approved Documents.
5. The drawing is the copyright of SP Architects and must only be reproduced with the written permission.

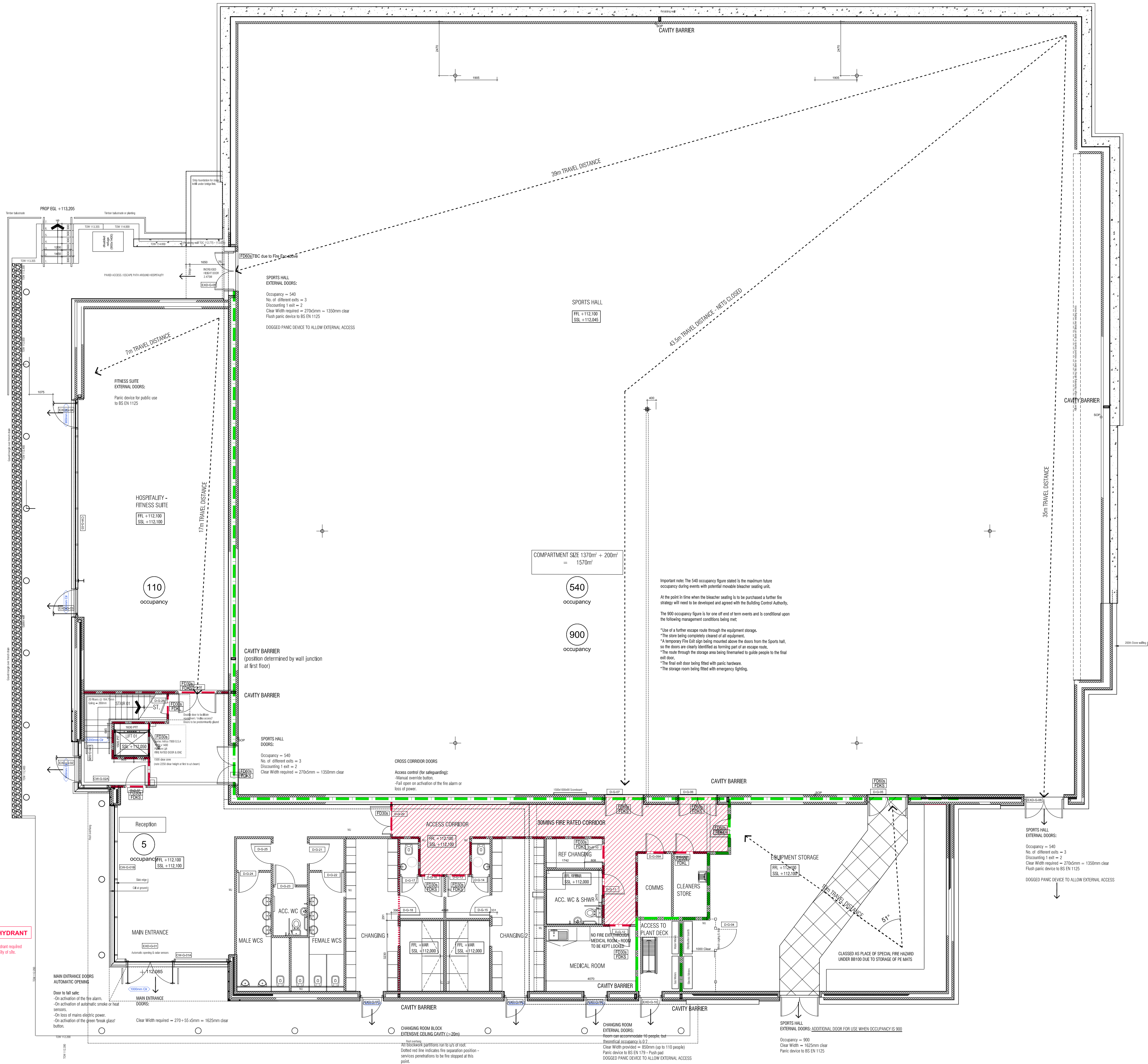

- KEY**
- 60 Minutes fire resisting construction
 - 30 Minutes fire resisting construction
 - 120 Minutes fire resisting construction
 - 30 Minutes fire resisting construction in Ceiling cavity
 - 60 minutes fire self closing and smoke resisting doorset
Self closers to comply with BS 7273 Part 4 Category A
 - 30 minutes fire self closing and smoke resisting doorset
Self closers to comply with BS 7273 Part 4 Category A
 - Denotes door to be on hold open device linked to fire alarm
 - Denotes 30 minutes integrity and insulation required to FR Glazed Screens
 - 30 Minutes fire protected corridor
 - Final Exit
 - Effective clear width of stair or doorway
 - Maximum Room occupancy
 - Disabled refuge point with 2 way communication device
 - Cavity Barrier - 30 MINS FR

Note: The Fire Strategy is subject to approval by the Approved Inspectors and the Local Fire Authority.

Note: Some requirements of BS100 incorporated, however method of compliance to be via ADB as agreed with the AL as the building is stand alone.

Fire Strategy Notes: Purpose Group (5) Assembly

- *Unsprinklered Building under 2000m², less than 10m to top storey.
- *All elements of structure to receive 60 minutes fire protection in accordance with AD part 8, tables A1 and A2. Internal face of external wall to provide oblique resistance from inside to outside.
- *Fire protection to extend to all exposed faces of steel beams and support angles or box sections. All beams providing support/restraint to walls/floors and areas of roof mounted plant over to be fire protected.
- *All compartmentation to receive 60 minutes fire protection in accordance with AD part 8, tables A1 and A2. Protected Corridor Walls as noted on plans - All partition walls extend up to the structural soffit above maintaining integrity of the enclosure.
- *Where fire doors occur fire wall or cavity barrier to continue over.
- *Cavity barriers to be provided to allow for continuity of compartmentation within cavity wall construction.
- *Cavity barriers in ceiling void to be provided at max 20m distance in any one direction.
- *Any pipe/duct penetration greater than 40mm diameter through the resisting floors/walls/cavity barriers or fire resisting cappings should be fire sleeved/dampened to match fire resistance of the penetrated element.

General Access & Equipment Provision



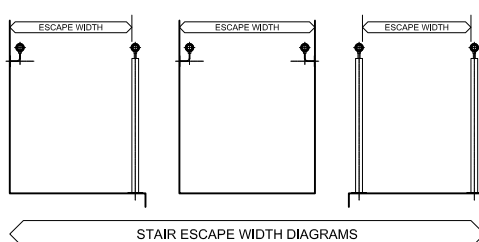



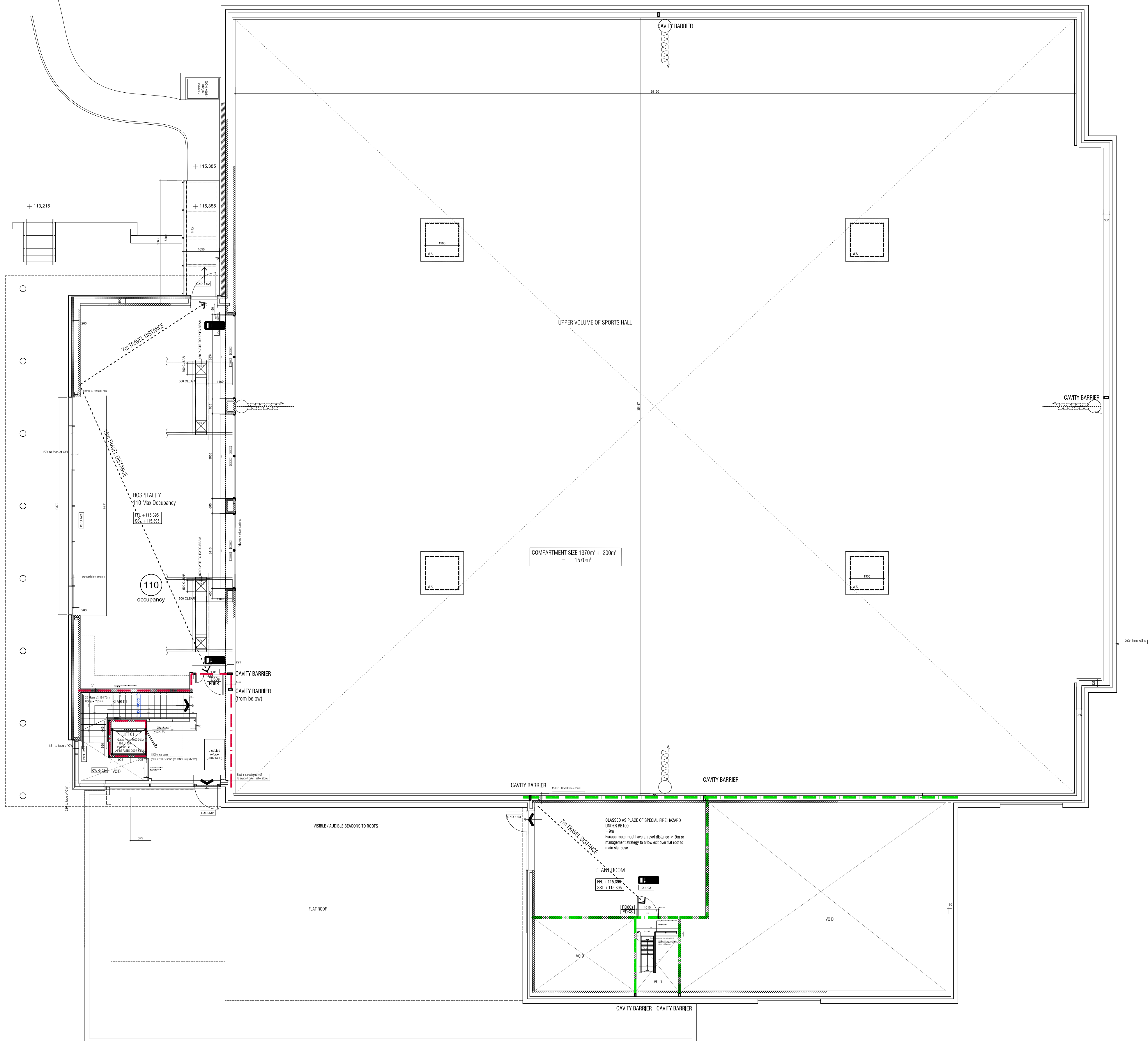







- *Fire detection and emergency lighting all in accordance with M+E designers drawings and specification.
- *Fire alarm system to be installed in accordance with BS5839 part 1:2013
- *Emergency lighting to be installed in accordance with BS5266 part 1: 2005 to be provided to all accommodation.
- *Emergency lighting to be installed in accordance with health and safety regulations 1996 and BS5499 part 1:2002.
- *Fire fighting equipment to be installed in accordance with BS5306 part 3:2003 to the approval of Building Control and Fire Officer.
- *All internal stairs are designed for simultaneous evacuation.
- *Escape stair clear widths in acc with AD part 8, Table 7 as noted on the fire strategy plans
- *Travel distances not to exceed 18m in any one direction, 45m in multiple directions.
- *Escape door clear widths to be as stated on plans.
- *All emergency fire exit doors are to incorporate quick release opening mechanisms, as noted on the fire strategy plans.
- *Corridors over 12m in length to be split by self closing fire rated cavity barriers over.
- *All fire rated doors (as stated on plans) to be self closing with smoke seals.
- *Inner room situation - the access room to an inner room should be fitted with a suitable automatic fire detection and alarm system to warn the occupants of the inner room of the outbreak of a fire in the access room, or alternatively provide min 0.1m² vision panel in door or wall
- *Disabled refuge - 900x1400 in accordance with BS 5588 part 8:1999, 2 way communication link to be installed to contact evacuation management, a blue mandatory sign "Refuge - keep clear" should be included. The management procedure for checking and evacuating disabled refuges in the event of a fire as BS 5588 part 8:1999 clause 13.
- *Surface finishes - class '0' - means of escape, class '1' - generally. Upholstery and furniture - BS 5822: 1999.
- *Fire tender access to be afforded to minimum 15% of the building footprint (Building not to exceed 11m to top in accordance with AD part 8, Table 19, No internal dry riser provided).
- *Fire appliance turning area within 20m of road dead end.



1. Do not scale from this drawing - use figure dimensions only
2. All person dimensions, levels, building positions and site boundaries to be checked by the Contractor, with any discrepancies reported before work starts
3. All works to be carried out to the satisfaction of the Local Authority and in accordance with Building Regulations, British Standards, CDM Regulations, Codes of Practice, Acts & Bylaws, manufacturers recommendations, specialist information and good building practice
4. References to Local Authority are also intended to read as for Approved Inspectors
5. This drawing is the copyright of SPX Architects and should only be reproduced with their written permission



KEY

- | | |
|---|---|
|  | 60 Minutes fire resisting construction |
|  | 30 Minutes fire resisting construction |
|  | 120 Minutes fire resisting construction |
|  | 30 Minutes fire resisting construction in Ceiling cavity |
|  | |
|  | 60 minutes fire self closing and smoke resisting doorset
Self closers to comply with BS 7273 Part 4 Category A |
|  | 30 minutes fire self closing and smoke resisting doorset
Self closers to comply with BS 7273 Part 4 Category A |
|  | Denotes door to be on hold open device linked to fire alarm |
|  | Denotes 30 minutes integrity and insulation required to FR Glazed Screens |
|  | 30 Minutes fire protected corridor |
|  | Final Exit |
|  | Effective clear width of stair or doorway |
|  | Maximum Room occupancy |
|  | Disabled refuge panel with 2 way communication device |
|  | Cavity Barrier - 30 MINS FR |

Note: The Fire Strategy is subject to approval by the Approved Inspectors and the Local Fire Authority.

Note: Some requirements of BB100 incorporated, however method of compliance to be via ADB as agreed with the AJ as the building is 'stand alone'

Fire Strategy Notes: Purpose Group (5) Assembly

- **"Unprotected Building under 60 minutes:** less than 10m to top story.
 - All elements of structure to receive 60 minutes fire protection in accordance with AD part 8, tables A1 & A2. Internal face of external wall to provide 60mins fire resistance from inside to outside.
 - "Fire protection to extend to all exposed faces of steel beams and steel columns or box columns. All beams providing support/reaction to wall/floors and areas of roof mounted plant over to be fire protected."
 - All compartmentation to receive 60 minutes fire protection in accordance with AD part 8, tables A1 & A2. Protected Corridor Walls as noted on plans - All partition walls extend up to the structural ceiling level.
 - "Where fire doors occur fire wall or cavity barrier to continue over."
 - "Cavity barriers to be provided to allow for continuity of compartmentation within cavity wall construction."
 - "Cavity barriers in ceiling void to be provided at max 20m distance in any one direction."
 - "Any specific penetration greater than 40mm diameter through the fire wall/cavity barriers or the ceiling/capings should be fire sleeved/dampened to match fire resistance of the penetrated element."

General Access & Equipment Provision

- *Fire detection and emergency lighting shall all in accordance with M-E designers drawings and specification.
- *"Fire alarm system to be installed in accordance with BS5839 part 1 2003
- *"Escape route doors to be installed in accordance with BS5566 part 1 2005 to provide access at all accommodation.
- *"Emergency lighting to be installed in accordance with health and safety legislation.
- *"Fire fighting equipment to be installed in accordance with BS5306 part 3 2003 to the approval of Building Control and Fire Officer.
- *"All internal stairs are designed for simultaneous evacuation.
- *"Escape route door widths as per AD Part 10, Table C7 as noted on the fire strategy plans.
- *"Travel distances not to exceed 18m in any one direction, 45m in multiple directions.
- *"Escape door exit doors to be as stated on plans.
- *"All emergency fire exit routes are to incorporate crash releasing operating mechanisms, as shown on the fire strategy plans.
- *"Escapes over 15m in length to be safely lit by ceiling fire rated cavity batten covers, over.
- *"All fire rated doors (as stated on plans) to be fire dooring should be fitted with a suitable automatic fire detection and alarm system to warn the occupants of the inner room of the outbreak of a fire in the access room, or corridor immediately adjoining the inner room, or the escape route or wall.
- *"Disabled refuge - 900x1400 in accordance with BS 5586 part 8 1999, 2 way communication link to be installed to control evacuation management.
- *"Smoke detectors to be installed in accordance with BS 5839 part 1 2003 management procedure for checking and evacuating disabled refuges in the event of a fire BS 5586 part 8 1999 clause 13.
- *"Surface finishes - class 0 – means of escape, class 1 – generally, elsewhere and class 2 – elsewhere.
- *"Fire tender access to be allowed to minimum 15% of the building footprint (Building not to exceed 11m in top log in accordance with Part B).
- *"The appliance turning area within 20 m of dead end exit.

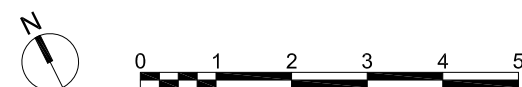
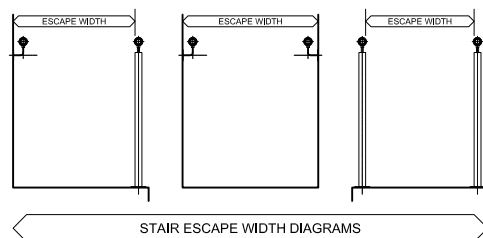

client	BASE VOYS LIMITED	scale	1:1100 @ A1	status	FINAL CONSTRUCTION ISSUE
site	SEORGHOGH SCHOOL STATION ROAD SEORGHOGH LATH SHAH	revision	1	date	AUGUST 2017
project	PROPOSED NEW SPORTS HALL	revision notes	1) Obtain following discussion with the AL, the school and LATH SHAH comments 2) Final Construction Issue		
number	016163-236				
drawing	FIRE STRATEGY - FIRST FLOOR				

