

Application for a premises licence to be granted under the Licensing Act 2003

PLEASE READ THE FOLLOWING INSTRUCTIONS FIRST

Before completing this form please read the guidance notes at the end of the form. If you are completing this form by hand please write legibly in block capitals. In all cases ensure that your answers are inside the boxes and written in black ink. Use additional sheets if necessary.

You may wish to keep a copy of the completed form for your records.

I/We Maxine Muir, Selma Gomes & Michael Latham – The Deli @ Limited

(Insert name(s) of applicant)

apply for a premises licence under section 17 of the Licensing Act 2003 for the premises described in Part 1 below (the premises) and I/we are making this application to you as the relevant licensing authority in accordance with section 12 of the Licensing Act 2003

Part 1 – Premises details

Postal address of premises or, if none, ordnance survey map reference or description			
95 & 95a Highgate			
Post town	Kendal	Postcode	LA9 4EN

Telephone number at premises (if any)	██████████
Non-domestic rateable value of premises	£ ██████████

Part 2 - Applicant details

Please state whether you are applying for a premises licence as **Please tick as appropriate**

- a) an individual or individuals * please complete section (A)
- b) a person other than an individual *
 - i as a limited company/limited liability partnership please complete section (B) ✓
 - ii as a partnership (other than limited liability) please complete section (B)
 - iii as an unincorporated association or please complete section (B)
 - iv other (for example a statutory corporation) please complete section (B)
- c) a recognised club please complete section (B)
- d) a charity please complete section (B)

- e) the proprietor of an educational establishment please complete section (B)
- f) a health service body please complete section (B)
- g) a person who is registered under Part 2 of the Care Standards Act 2000 (c14) in respect of an independent hospital in Wales please complete section (B)
- ga) a person who is registered under Chapter 2 of Part 1 of the Health and Social Care Act 2008 (within the meaning of that Part) in an independent hospital in England please complete section (B)
- h) the chief officer of police of a police force in England and Wales please complete section (B)

* If you are applying as a person described in (a) or (b) please confirm (by ticking yes to one box below):

I am carrying on or proposing to carry on a business which involves the use of the
 premises for licensable activities; or

I am making the application pursuant to a
 statutory function or
 a function discharged by virtue of Her Majesty's prerogative

(A) INDIVIDUAL APPLICANTS (fill in as applicable)

Mr	Mrs	Miss	Ms	Other Title (for example, Rev)	
Surname			First names		
Date of birth		I am 18 years old or over		Please tick yes	
Nationality					
Current residential address if different from premises address					
Post town				Postcode	
Daytime contact telephone number					
E-mail address (optional)					
Where applicable (if demonstrating a right to work via the Home Office online right to work checking service), the 9-digit 'share code' provided to the applicant by that service (please see note 15 for information)					

SECOND INDIVIDUAL APPLICANT (if applicable)

Mr	Mrs	Miss	Ms	Other Title (for example, Rev)	
Surname			First names		
Date of birth		I am 18 years old or over		Please tick yes	
Nationality					
Where applicable (if demonstrating a right to work via the Home Office online right to work checking service), the 9-digit 'share code' provided to the applicant by that service: (please see note 15 for information)					
Current residential address if different from premises address					
Post town				Postcode	
Daytime contact telephone number					
E-mail address (optional)					

(B) OTHER APPLICANTS

Please provide name and registered address of applicant in full. Where appropriate please give any registered number. In the case of a partnership or other joint venture (other than a body corporate), please give the name and address of each party concerned.

Name The Deli @ Limited
Address [REDACTED]
Registered number (where applicable) 12812481
Description of applicant (for example, partnership, company, unincorporated association etc.) Private Limited Company

Telephone number (if any) [REDACTED]

E-mail address (optional) [REDACTED]

Part 3 Operating Schedule

When do you want the premises licence to start?

DD	MM	YYYY
0	1	0 2 2 0 2 1

If you wish the licence to be valid only for a limited period, when do you want it to end?

DD	MM	YYYY

Please give a general description of the premises (please read guidance note 1)

The Deli @ 95 is a Deli and Deli Retail specializing in predominantly local Cumbrian produce, by joining two shops we will be offering a Deli Retail section in which we would like to stock locally produced gins etc. and a deli which sells cheese, charcuterie, antipasti, coffee to go and artisan sandwiches

If 5,000 or more people are expected to attend the premises at any one time, please state the number expected to attend.

What licensable activities do you intend to carry on from the premises?

(please see sections 1 and 14 and Schedules 1 and 2 to the Licensing Act 2003)

Provision of regulated entertainment (please read guidance note 2)

Please tick all that apply

- a) plays (if ticking yes, fill in box A)
- b) films (if ticking yes, fill in box B)
- c) indoor sporting events (if ticking yes, fill in box C)
- d) boxing or wrestling entertainment (if ticking yes, fill in box D)
- e) live music (if ticking yes, fill in box E)
- f) recorded music (if ticking yes, fill in box F)
- g) performances of dance (if ticking yes, fill in box G)
- h) anything of a similar description to that falling within (e), (f) or (g) (if ticking yes, fill in box H)

Provision of late night refreshment (if ticking yes, fill in box I)

Supply of alcohol (if ticking yes, fill in box J)

In all cases complete boxes K, L and M

A

Plays Standard days and timings (please read guidance note 7)			Will the performance of a play take place <u>indoors or outdoors or both</u> – please tick (please read guidance note 3)	Indoors	
Day	Start	Finish		Outdoors	
Mon				<u>Please give further details here</u> (please read guidance note 4)	Both
Tue					
Wed			<u>State any seasonal variations for performing plays</u> (please read guidance note 5)		
Thur					
Fri			<u>Non standard timings. Where you intend to use the premises for the performance of plays at different times to those listed in the column on the left, please list</u> (please read guidance note 6)		
Sat					
Sun					

B

Films Standard days and timings (please read guidance note 7)			Will the exhibition of films take place indoors or outdoors or both – please tick (please read guidance note 3)	Indoors	
				Outdoors	
Day	Start	Finish		Both	
Mon			Please give further details here (please read guidance note 4)		
	-----	-----			
Tue			State any seasonal variations for the exhibition of films (please read guidance note 5)		
	-----	-----			
Wed			Non standard timings. Where you intend to use the premises for the exhibition of films at different times to those listed in the column on the left, please list (please read guidance note 6)		
	-----	-----			
Thur					
	-----	-----			
Fri					
	-----	-----			
Sat					
	-----	-----			
Sun					
	-----	-----			

C

Indoor sporting events Standard days and timings (please read guidance note 7)			<u>Please give further details</u> (please read guidance note 4)
Day	Start	Finish	
Mon			<u>State any seasonal variations for indoor sporting events</u> (please read guidance note 5)
Tue			
Wed			
Thur			<u>Non standard timings. Where you intend to use the premises for indoor sporting events at different times to those listed in the column on the left, please list</u> (please read guidance note 6)
Fri			
Sat			
Sun			

D

Boxing or wrestling entertainments Standard days and timings (please read guidance note 7)			Will the boxing or wrestling entertainment take place indoors or outdoors or both – please tick (please read guidance note 3)	Indoors	
				Outdoors	
Day	Start	Finish		Both	
Mon			Please give further details here (please read guidance note 4)		
Tue					
Wed			State any seasonal variations for boxing or wrestling entertainment (please read guidance note 5)		
Thur					
Fri			Non standard timings. Where you intend to use the premises for boxing or wrestling entertainment at different times to those listed in the column on the left, please list (please read guidance note 6)		
Sat					
Sun					

E

Live music Standard days and timings (please read guidance note 7)			<u>Will the performance of live music take place indoors or outdoors or both – please tick</u> (please read guidance note 3)	Indoors	
				Outdoors	
				Both	
Day	Start	Finish	<u>Please give further details here</u> (please read guidance note 4)		
Mon	-----	-----			
Tue	-----	-----	<u>State any seasonal variations for the performance of live music</u> (please read guidance note 5)		
Wed	-----	-----			
Thur	-----	-----	<u>Non standard timings. Where you intend to use the premises for the performance of live music at different times to those listed in the column on the left, please list</u> (please read guidance note 6)		
Fri	-----	-----			
Sat	-----	-----			
Sun	-----	-----			

F

Recorded music Standard days and timings (please read guidance note 7)			Will the playing of recorded music take place indoors or outdoors or both – please tick (please read guidance note 3)		Indoors	
					Outdoors	
Day	Start	Finish			Both	
Mon			<u>Please give further details here</u> (please read guidance note 4)			
Tue						
Wed			<u>State any seasonal variations for the playing of recorded music</u> (please read guidance note 5)			
Thur						
Fri			<u>Non standard timings. Where you intend to use the premises for the playing of recorded music at different times to those listed in the column on the left, please list</u> (please read guidance note 6)			
Sat						
Sun						

G

Performances of dance Standard days and timings (please read guidance note 7)			<u>Will the performance of dance take place indoors or outdoors or both – please tick</u> (please read guidance note 3)	Indoors	
				Outdoors	
Day	Start	Finish		Both	
Mon	-----		<u>Please give further details here</u> (please read guidance note 4)		
Tue	-----				
Wed	-----		<u>State any seasonal variations for the performance of dance</u> (please read guidance note 5)		
Thur	-----				
Fri	-----		<u>Non standard timings. Where you intend to use the premises for the performance of dance at different times to those listed in the column on the left, please list</u> (please read guidance note 6)		
Sat	-----				
Sun	-----				

H

Anything of a similar description to that falling within (e), (f) or (g) Standard days and timings (please read guidance note 7)			Please give a description of the type of entertainment you will be providing		
Day	Start	Finish	<u>Will this entertainment take place indoors or outdoors or both – please tick</u> (please read guidance note 3)	Indoors	
Mon				Outdoors	
				Both	
Tue			<u>Please give further details here</u> (please read guidance note 4)		
Wed					
Thur			<u>State any seasonal variations for entertainment of a similar description to that falling within (e), (f) or (g)</u> (please read guidance note 5)		
Fri					
Sat			<u>Non standard timings. Where you intend to use the premises for the entertainment of a similar description to that falling within (e), (f) or (g) at different times to those listed in the column on the left, please list</u> (please read guidance note 6)		
Sun					

I

Late night refreshment Standard days and timings (please read guidance note 7)			Will the provision of late night refreshment take place indoors or outdoors or both – please tick (please read guidance note 3)	Indoors	
				Outdoors	
Day	Start	Finish		Both	
Mon	-----	-----	<u>Please give further details here</u> (please read guidance note 4)		
Tue	-----	-----			
Wed	-----	-----	<u>State any seasonal variations for the provision of late night refreshment</u> (please read guidance note 5)		
Thur	-----	-----			
Fri	-----	-----	<u>Non standard timings. Where you intend to use the premises for the provision of late night refreshment at different times, to those listed in the column on the left, please list</u> (please read guidance note 6)		
Sat	-----	-----			
Sun	-----	-----			

J

Supply of alcohol Standard days and timings (please read guidance note 7)			Will the supply of alcohol be for consumption – please tick (please read guidance note 8)	On the premises	<input type="checkbox"/>
				Off the premises	<input checked="" type="checkbox"/>
				Both	<input type="checkbox"/>
Day	Start	Finish	State any seasonal variations for the supply of alcohol (please read guidance note 5)		
Mon	08h00	18h00			
Tue	08h00	18h00			
Wed	08h00	18h00			
Thur	08h00	18h00			
Fri	08h00	18h00			
Sat	08h00	18h00			
Sun	08h00	18h00			
			Non standard timings. Where you intend to use the premises for the supply of alcohol at different times to those listed in the column on the left, please list (please read guidance note 6)		

State the name and details of the individual whom you wish to specify on the licence as designated premises supervisor (Please see declaration about the entitlement to work in the checklist at the end of the form):

Name		██████████
Date of birth		1/12/1971
Address		
██		
Postcode		██████████
Personal licence number (if known) PA040795		

Issuing licensing authority (if known) South Lakeland District Council

K

Please highlight any adult entertainment or services, activities, other entertainment or matters ancillary to the use of the premises that may give rise to concern in respect of children (please read guidance note 9).

L

Hours premises are open to the public Standard days and timings (please read guidance note 7)			State any seasonal variations (please read guidance note 5)
Day	Start	Finish	
Mon	0800	18h00	Non standard timings. Where you intend the premises to be open to the public at different times from those listed in the column on the left, please list (please read guidance note 6)
	-----	-----	
Tue	8h00	18h00	
	-----	-----	
Wed	08h00	18h00	
	-----	-----	
Thur	08h00	18h00	
	-----	-----	
Fri	08h00	18h00	
	-----	-----	
Sat	08h00	18h00	
	-----	-----	

Sun	08h00	18h00	
-----	-------	-------	--

M

Describe the steps you intend to take to promote the four licensing objectives:

a) General – all four licensing objectives (b, c, d and e) (please read guidance note 10)

I will ensure that all staff are trained and are made aware of the below licencing objectives and that they are maintained at all times.

b) The prevention of crime and disorder

An incident book will be maintained and kept on the premises at all times available for inspection

c) Public safety

I will ensure that all staff receive appropriate training about emergency and general safety precautions and procedures.

I will ensure that all staff are aware of their social and legal obligations and their responsibilities regarding the sale of alcohol.

The electrical system at the premises, including portable appliances must be inspected and tested annually by a competent person and a satisfactory safety report obtained.

All safety certificates and inspection reports must be kept on site and made available for inspection

The fire safety measures provided on the premises must be maintained in good working order, and their adequacy will be determined on a regular basis.

An adequate and appropriate supply of first aid equipment and materials must be available on the premises

d) The prevention of public nuisance

Only ambient background music will be played in the shop

e) The protection of children from harm

A proof of age policy agreed in writing will be enforced.

A challenge 21/25 policy must be employed where those individuals who appear to be under the age of 21/25 attempting to purchase alcohol must be asked for identification. The only type of ID that will be accepted is PASS accredited ID, passport or photo driving licence.

Checklist:

Please tick to indicate agreement

- I have made or enclosed payment of the fee.
- I have enclosed the plan of the premises.
- I have sent copies of this application and the plan to responsible authorities and others where applicable.
- I have enclosed the consent form completed by the individual I wish to be designated premises supervisor, if applicable.
- I understand that I must now advertise my application.
- I understand that if I do not comply with the above requirements my application will be rejected.
- [Applicable to all individual applicants, including those in a partnership which is not a limited liability partnership, but not companies or limited liability partnerships] I have included documents demonstrating my entitlement to work in the United Kingdom or my share code issued by the Home Office online right to work checking service (please read note 15).

IT IS AN OFFENCE, UNDER SECTION 158 OF THE LICENSING ACT 2003, TO MAKE A FALSE STATEMENT IN OR IN CONNECTION WITH THIS APPLICATION. THOSE WHO MAKE A FALSE STATEMENT MAY BE LIABLE ON SUMMARY CONVICTION TO A FINE OF ANY AMOUNT.

IT IS AN OFFENCE UNDER SECTION 24B OF THE IMMIGRATION ACT 1971 FOR A PERSON TO WORK WHEN THEY KNOW, OR HAVE REASONABLE CAUSE TO BELIEVE, THAT THEY ARE DISQUALIFIED FROM DOING SO BY REASON OF THEIR IMMIGRATION STATUS. THOSE WHO EMPLOY AN ADULT WITHOUT LEAVE OR WHO IS SUBJECT TO CONDITIONS AS TO EMPLOYMENT WILL BE LIABLE TO A CIVIL PENALTY UNDER SECTION 15 OF THE IMMIGRATION, ASYLUM AND NATIONALITY ACT 2006 AND PURSUANT TO SECTION 21 OF THE SAME ACT, WILL BE COMMITTING AN OFFENCE WHERE THEY DO SO IN THE

KNOWLEDGE, OR WITH REASONABLE CAUSE TO BELIEVE, THAT THE EMPLOYEE IS DISQUALIFIED.





Part 4 – Signatures (please read guidance note 11)

Signature of applicant or applicant’s solicitor or other duly authorised agent (see guidance note 12). If signing on behalf of the applicant, please state in what capacity.

Declaration	<ul style="list-style-type: none"> • [Applicable to individual applicants only, including those in a partnership which is not a limited liability partnership] I understand I am not entitled to be issued with a licence if I do not have the entitlement to live and work in the UK (or if I am subject to a condition preventing me from doing work relating to the carrying on of a licensable activity) and that my licence will become invalid if I cease to be entitled to live and work in the UK (please read guidance note 15). • The DPS named in this application form is entitled to work in the UK (and is not subject to conditions preventing him or her from doing work relating to a licensable activity) and I have seen a copy of his or her proof of entitlement to work, or have conducted an online right to work check using the Home Office online right to work checking service which confirmed their right to work (please see note 15)
Signature	
Date	25/11/2020
Capacity	Director

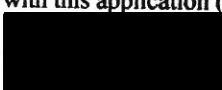
For joint applications, signature of 2nd applicant or 2nd applicant’s solicitor or other authorised agent (please read guidance note 13). If signing on behalf of the applicant, please state in what capacity.

Signature	
Date	
Capacity	

Contact name (where not previously given) and postal address for correspondence associated with this application (please read guidance note 14)			
			
Post town		Postcode	
Telephone number (if any)			

Consent of individual to being specified as premises supervisor

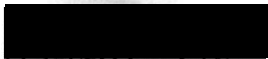
I 
[full name of prospective premises supervisor]

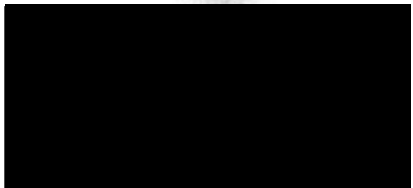
of 

[home address of prospective premises supervisor]

hereby confirm that I give my consent to be specified as the designated premises supervisor in relation to the application for

[type of application]

by 
[name of applicant]

relating to a premises licence PA040795
[number of existing licence, if any]

for

The Deli @ 95, 95 & 95^a Highgate, Kendal, LA9 4EN
[name and address of premises to which the application relates]

and any premises licence to be granted or varied in respect of this application made by

[name of applicant]

concerning the supply of alcohol at

The Deli @ 95, 95 & 95^a Highgate, Kendal, LA9 4EN
[name and address of premises to which application relates]

I also confirm that I am entitled to work in the United Kingdom and am applying for, intend to apply for or currently hold a personal licence, details of which I set out below.

Personal licence number

PA040795
[insert personal licence number, if any]

Personal licence issuing authority

Public Protection Group, SouthLakeland House, Central St, Kendal, LA9 4DQ.
[insert name and address and telephone number of personal licence issuing authority, if any]

Signed



Name (please print)



Date

21/11/2020

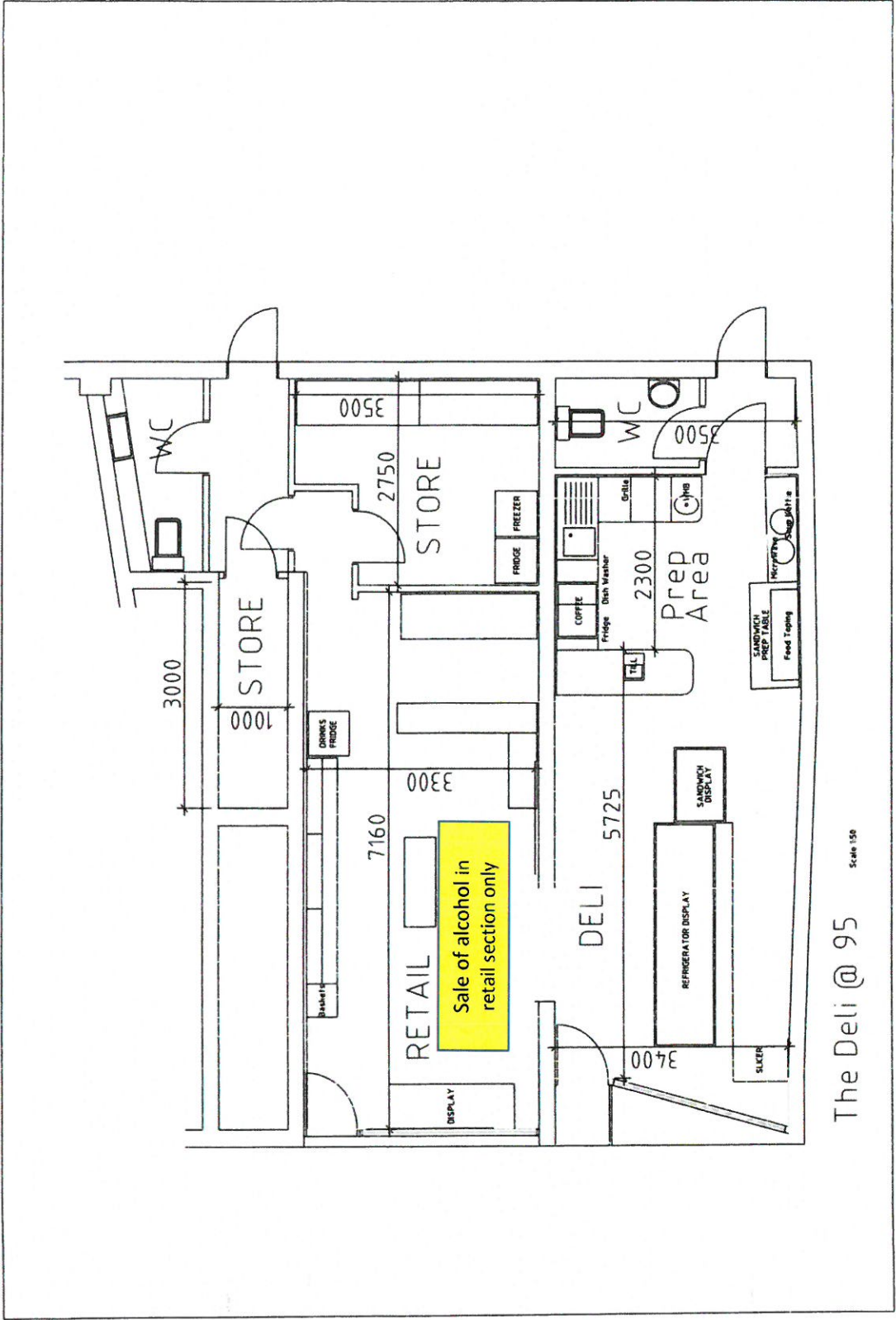

The Deli @ 95

Scale 1:50

