

**Application for a premises licence to be granted
under the Licensing Act 2003**

PLEASE READ THE FOLLOWING INSTRUCTIONS FIRST

Before completing this form please read the guidance notes at the end of the form. If you are completing this form by hand please write legibly in block capitals. In all cases ensure that your answers are inside the boxes and written in black ink. Use additional sheets if necessary.

You may wish to keep a copy of the completed form for your records.

I/We Boaters Bowness Limited

(Insert name(s) of applicant)

apply for a premises licence under section 17 of the Licensing Act 2003 for the premises described in Part 1 below (the premises) and I/we are making this application to you as the relevant licensing authority in accordance with section 12 of the Licensing Act 2003

Part 1 – Premises details

Postal address of premises or, if none, ordnance survey map reference or description			
Boaters Bowness Windermere Quays Glebe Road Bowness on Windermere Cumbria		<i>South Lakeland District Council Public Protection</i> 31 JUL 2019	
Post town	Bowness on Windermere	Postcode	LA23 3HE

Telephone number at premises (if any)	N/A
Non-domestic rateable value of premises	£36,500

Part 2 - Applicant details

Please state whether you are applying for a premises licence as appropriate

Please tick as

- | | |
|--|---|
| a) an individual or individuals * | <input type="checkbox"/> please complete section (A) |
| b) a person other than an individual * | |
| i as a limited company/limited liability partnership | <input checked="" type="checkbox"/> please complete section (B) |
| ii as a partnership (other than limited liability) | <input type="checkbox"/> please complete section (B) |

Receipt No 027595 (CRE)
Initials R-J
Date 31/07/19

- iii as an unincorporated association or ☐ please complete section (B)
- iv other (for example a statutory corporation) ☐ please complete section (B)
- c) a recognised club ☐ please complete section (B)
- d) a charity ☐ please complete section (B)
- e) the proprietor of an educational establishment ☐ please complete section (B)
- f) a health service body ☐ please complete section (B)
- g) a person who is registered under Part 2 of the Care Standards Act 2000 (c14) in respect of an independent hospital in Wales ☐ please complete section (B)
- ga) a person who is registered under Chapter 2 of Part 1 of the Health and Social Care Act 2008 (within the meaning of that Part) in an independent hospital in England ☐ please complete section (B)
- h) the chief officer of police of a police force in England and Wales ☐ please complete section (B)

* If you are applying as a person described in (a) or (b) please confirm (by ticking yes to one box below):

I am carrying on or proposing to carry on a business which involves the use of the premises for licensable activities; or ☒

I am making the application pursuant to a statutory function or ☐

a function discharged by virtue of Her Majesty's prerogative ☐

(A) INDIVIDUAL APPLICANTS (fill in as applicable)

Mr <input type="checkbox"/>	Mrs <input type="checkbox"/>	Miss <input type="checkbox"/>	Ms <input type="checkbox"/>	Other Title (for example, Rev) <input type="checkbox"/>
Surname		First names		
Date of birth		I am 18 years old or over <input type="checkbox"/> Please tick yes		
Nationality				
Current residential address if different from premises address				
Post town		Postcode		
Daytime contact telephone number				
E-mail address (optional)				

SECOND INDIVIDUAL APPLICANT (if applicable)

Mr <input type="checkbox"/>	Mrs <input type="checkbox"/>	Miss <input type="checkbox"/>	Ms <input type="checkbox"/>	Other Title (for example, Rev)	
Surname			First names		
Date of birth		I am 18 years old or over		<input type="checkbox"/> Please tick yes	
Nationality					
Current residential address if different from premises address					
Post town				Postcode	
Daytime contact telephone number					
E-mail address (optional)					

(B) OTHER APPLICANTS

Please provide name and registered address of applicant in full. Where appropriate please give any registered number. In the case of a partnership or other joint venture (other than a body corporate), please give the name and address of each party concerned.

Name Boaters Bowness Limited
Address Unit 3 & 4 Kincaig Court Kincaig Road Bispham Lancashire FY2 0FY
Registered number (where applicable) 12068869
Description of applicant (for example, partnership, company, unincorporated association etc.) Private Limited Company
Telephone number (if any) 01253 851111
E-mail address (optional) info@boatersbowness.com

Part 3 Operating Schedule

When do you want the premises licence to start?

DD		MM		YYYY			
2	9	0	8	2	0	1	9

If you wish the licence to be valid only for a limited period, when do you want it to end?

DD		MM		YYYY			
+	+	+	+	+	+	+	+

Please give a general description of the premises (please read guidance note 1)

It is intended that the premises will be a bar and lounge catering largely for the boating community who utilise Lake Windermere. The premises will offer coffees, soft drinks and alcoholic drinks with a focus on quality craft ale in a relaxed atmosphere which is family-friendly. It is also intended that the premises will offer occasional regulated entertainment.

If 5,000 or more people are expected to attend the premises at any one time, please state the number expected to attend.

N/A

What licensable activities do you intend to carry on from the premises?

(please see sections 1 and 14 and Schedules 1 and 2 to the Licensing Act 2003)

Provision of regulated entertainment (please read guidance note 2)

Please tick all that apply

- | | |
|---|-------------------------------------|
| a) plays (if ticking yes, fill in box A) | <input type="checkbox"/> |
| b) films (if ticking yes, fill in box B) | <input checked="" type="checkbox"/> |
| c) indoor sporting events (if ticking yes, fill in box C) | <input type="checkbox"/> |
| d) boxing or wrestling entertainment (if ticking yes, fill in box D) | <input type="checkbox"/> |
| e) live music (if ticking yes, fill in box E) | <input checked="" type="checkbox"/> |
| f) recorded music (if ticking yes, fill in box F) | <input checked="" type="checkbox"/> |
| g) performances of dance (if ticking yes, fill in box G) | <input checked="" type="checkbox"/> |
| h) anything of a similar description to that falling within (e), (f) or (g) (if ticking yes, fill in box H) | <input checked="" type="checkbox"/> |

Provision of late night refreshment (if ticking yes, fill in box I)

☐

Supply of alcohol (if ticking yes, fill in box J)

☐

In all cases complete boxes K, L and M

A

Plays Standard days and timings (please read guidance note 7)			<u>Will the performance of a play take place indoors or outdoors or both – please tick</u> (please read guidance note 3)	Indoors	<input type="checkbox"/>
				Outdoors	<input type="checkbox"/>
				Both	<input type="checkbox"/>
Day	Start	Finish			
Mon			<u>Please give further details here</u> (please read guidance note 4)		
Tue					
Wed			<u>State any seasonal variations for performing plays</u> (please read guidance note 5)		
Thur					
Fri			<u>Non standard timings. Where you intend to use the premises for the performance of plays at different times to those listed in the column on the left, please list</u> (please read guidance note 6)		
Sat					
Sun					

B

Films Standard days and timings (please read guidance note 7)			Will the exhibition of films take place indoors or outdoors or both – please tick (please read guidance note 3)	Indoors	<input checked="" type="checkbox"/>
				Outdoors	<input type="checkbox"/>
				Both	<input type="checkbox"/>
Day	Start	Finish	Please give further details here (please read guidance note 4)		
Mon	10:00	00:00			
Tue	10:00	00:00	State any seasonal variations for the exhibition of films (please read guidance note 5)		
Wed	10:00	00:00			
Thur	10:00	00:00	Non standard timings. Where you intend to use the premises for the exhibition of films at different times to those listed in the column on the left, please list (please read guidance note 6)		
Fri	10:00	02:00			
Sat	10:00	02:00	From 10:00 to 02:00 the following day on each of the following occasions: Maundy Thursday, Halloween, Christmas Eve, Boxing Day, New Year's Eve, St. George's Day, St. Patrick's Day and, any Sunday immediately preceding a Bank Holiday Monday.		
Sun	10:00	00:00			

C

Indoor sporting events Standard days and timings (please read guidance note 7)			<u>Please give further details</u> (please read guidance note 4)
Day	Start	Finish	
Mon			
Tue			<u>State any seasonal variations for indoor sporting events</u> (please read guidance note 5)
Wed			
Thur			<u>Non standard timings. Where you intend to use the premises for indoor sporting events at different times to those listed in the column on the left, please list</u> (please read guidance note 6)
Fri			
Sat			
Sun			

D

Boxing or wrestling entertainments Standard days and timings (please read guidance note 7)			Will the boxing or wrestling entertainment take place indoors or outdoors or both – please tick (please read guidance note 3)	Indoors	<input type="checkbox"/>
				Outdoors	<input type="checkbox"/>
				Both	<input type="checkbox"/>
Day	Start	Finish			
Mon			Please give further details here (please read guidance note 4)		
Tue					
Wed			State any seasonal variations for boxing or wrestling entertainment (please read guidance note 5)		
Thur					
Fri			Non standard timings. Where you intend to use the premises for boxing or wrestling entertainment at different times to those listed in the column on the left, please list (please read guidance note 6)		
Sat					
Sun					

E

Live music Standard days and timings (please read guidance note 7)			Will the performance of live music take place indoors or outdoors or both – please tick (please read guidance note 3)	Indoors <input checked="" type="checkbox"/>
				Outdoors <input type="checkbox"/>
				Both <input type="checkbox"/>
Day	Start	Finish		
Mon	10:00	00:00	<u>Please give further details here</u> (please read guidance note 4)	
Tue	10:00	00:00		
Wed	10:00	00:00	<u>State any seasonal variations for the performance of live music</u> (please read guidance note 5)	
Thur	10:00	00:00		
Fri	10:00	02:00	<u>Non standard timings. Where you intend to use the premises for the performance of live music at different times to those listed in the column on the left, please list</u> (please read guidance note 6)	
Sat	10:00	02:00		
Sun	10:00	00:00	From 10:00 to 02:00 the following day on each of the following occasions: Maundy Thursday, Halloween, Christmas Eve, Boxing Day, New Year's Eve, St. George's Day, St. Patrick's Day and, any Sunday immediately preceding a Bank Holiday Monday.	

F

Recorded music Standard days and timings (please read guidance note 7)			Will the playing of recorded music take place indoors or outdoors or both – please tick (please read guidance note 3)	Indoors	<input checked="" type="checkbox"/>
Day	Start	Finish		Outdoors	<input type="checkbox"/>
Mon	10:00	00:00	Please give further details here (please read guidance note 4)	Both	<input type="checkbox"/>
Tue	10:00	00:00			
Wed	10:00	00:00	State any seasonal variations for the playing of recorded music (please read guidance note 5)		
Thur	10:00	00:00			
Fri	10:00	02:00	Non standard timings. Where you intend to use the premises for the playing of recorded music at different times to those listed in the column on the left, please list (please read guidance note 6)		
Sat	10:00	02:00			
Sun	10:00	00:00			

From 10:00 to 02:00 the following day on each of the following occasions: Maundy Thursday, Halloween, Christmas Eve, Boxing Day, New Year's Eve, St. George's Day, St. Patrick's Day and, any Sunday immediately preceding a Bank Holiday Monday.

G

Performances of dance Standard days and timings (please read guidance note 7)			Will the performance of dance take place indoors or outdoors or both – please tick (please read guidance note 3)	Indoors	<input checked="" type="checkbox"/>
				Outdoors	<input type="checkbox"/>
				Both	<input type="checkbox"/>
Day	Start	Finish	Please give further details here (please read guidance note 4)		
Mon	10:00	00:00			
Tue	10:00	00:00			
			State any seasonal variations for the performance of dance (please read guidance note 5)		
Wed	10:00	00:00			
Thur	10:00	00:00			
			Non standard timings. Where you intend to use the premises for the performance of dance at different times to those listed in the column on the left, please list (please read guidance note 6) From 10:00 to 02:00 the following day on each of the following occasions: Maundy Thursday, Halloween, Christmas Eve, Boxing Day, New Year's Eve, St. George's Day, St. Patrick's Day and, any Sunday immediately preceding a Bank Holiday Monday.		
Fri	10:00	02:00			
Sat	10:00	02:00			
Sun	10:00	00:00			

H

Anything of a similar description to that falling within (e), (f) or (g) Standard days and timings (please read guidance note 7)			Please give a description of the type of entertainment you will be providing	
Day	Start	Finish	<u>Will this entertainment take place indoors or outdoors or both – please tick</u> (please read guidance note 3)	Indoors <input checked="" type="checkbox"/>
Mon	10:00	00:00		Outdoors <input type="checkbox"/>
Tue	10:00	00:00	<u>Please give further details here</u> (please read guidance note 4)	Both <input type="checkbox"/>
Wed	10:00	00:00		
Thur	10:00	00:00		
Fri	10:00	02:00	<u>State any seasonal variations for entertainment of a similar description to that falling within (e), (f) or (g)</u> (please read guidance note 5)	
Sat	10:00	02:00	<u>Non standard timings. Where you intend to use the premises for the entertainment of a similar description to that falling within (e), (f) or (g) at different times to those listed in the column on the left, please list</u> (please read guidance note 6)	
Sun	10:00	00:00	From 10:00 to 02:00 the following day on each of the following occasions: Maundy Thursday, Halloween, Christmas Eve, Boxing Day, New Year's Eve, St. George's Day, St. Patrick's Day and, any Sunday immediately preceding a Bank Holiday Monday.	

Late night refreshment Standard days and timings (please read guidance note 7)			Will the provision of late night refreshment take place indoors or outdoors or both – please tick (please read guidance note 3)	Indoors	<input checked="" type="checkbox"/>
				Outdoors	<input type="checkbox"/>
				Both	<input type="checkbox"/>
Day	Start	Finish	<u>Please give further details here</u> (please read guidance note 4)		
Mon	23:00	00:00			
Tue	23:00	00:00			
Wed	23:00	00:00	<u>State any seasonal variations for the provision of late night refreshment</u> (please read guidance note 5)		
Thur	23:00	00:00			
Fri	23:00	02:00			
Sat	23:00	02:00	<u>Non standard timings. Where you intend to use the premises for the provision of late night refreshment at different times, to those listed in the column on the left, please list</u> (please read guidance note 6)		
Sun	23:00	00:00			
			From 10:00 to 02:00 the following day on each of the following occasions: Maundy Thursday, Halloween, Christmas Eve, Boxing Day, New Year's Eve, St. George's Day, St. Patrick's Day and, any Sunday immediately preceding a Bank Holiday Monday.		

J

Supply of alcohol Standard days and timings (please read guidance note 7)			Will the supply of alcohol be for consumption – please tick (please read guidance note 8)	On the premises	<input type="checkbox"/>
				Off the premises	<input type="checkbox"/>
				Both	<input checked="" type="checkbox"/>
Day	Start	Finish	State any seasonal variations for the supply of alcohol (please read guidance note 5)		
Mon	10:00	00:00			
Tue	10:00	00:00			
Wed	10:00	00:00			
Thur	10:00	00:00	Non standard timings. Where you intend to use the premises for the supply of alcohol at different times to those listed in the column on the left, please list (please read guidance note 6) From 10:00 to 02:00 the following day on each of the following occasions: Maundy Thursday, Halloween, Christmas Eve, Boxing Day, New Year's Eve, St. George's Day, St. Patrick's Day and, any Sunday immediately preceding a Bank Holiday Monday.		
Fri	10:00	02:00			
Sat	10:00	02:00			
Sun	10:00	00:00			

State the name and details of the individual whom you wish to specify on the licence as designated premises supervisor (Please see declaration about the entitlement to work in the checklist at the end of the form):

Name Ryan Kinwood Bailey	
Date of birth	
Address	
Postcode	
Personal licence number (if known) 133032	
Issuing licensing authority (if known) Bolton Council	

K

Please highlight any adult entertainment or services, activities, other entertainment or matters ancillary to the use of the premises that may give rise to concern in respect of children (please read guidance note 9).

None currently anticipated.

L

Hours premises are open to the public Standard days and timings (please read guidance note 7)			State any seasonal variations (please read guidance note 5)
Day	Start	Finish	
Mon	07:00	00:30	
Tue	07:00	00:30	
Wed	07:00	00:30	
Thur	07:00	00:30	
Fri	07:00	02:30	
Sat	07:00	02:30	
Sun	07:00	00:30	
			Non standard timings. Where you intend the premises to be open to the public at different times from those listed in the column on the left, please list (please read guidance note 6) From 07:00 to 02:30 the following day on each of the following occasions: Maundy Thursday, Halloween, Christmas Eve, Boxing Day, New Year's Eve, St. George's Day, St. Patrick's Day and, any Sunday immediately preceding a Bank Holiday Monday.

M Describe the steps you intend to take to promote the four licensing objectives:

a) General – all four licensing objectives (b, c, d and e) (please read guidance note 10)

Upon commencement of their employment, all staff who are involved in the sale of alcohol will be trained in relation to the licensing objectives so as to reduce crime and disorder, promote public safety, prevent public nuisance and promote the protection of children from harm. Refresher training will be provided at least once every twelve months and all training will be documented and made available to an authorised officer upon request.

The premises will be an active member of any local "pub watch" or equivalent scheme where such a scheme is in existence.

b) The prevention of crime and disorder

A CCTV system shall be installed internally and externally at the premises and will meet the following criteria:

- The system will display on any recording the time and date of said recording;
- The system will be recording whenever the premises is open to the public;
- Images will be of evidential quality;
- Any recordings will be retained for a minimum of 31 days after they are made and will be produced to an authorised officer upon request, so long as said request is in accordance with the principles of the Data Protection Act or any subsequent or alternative legislation;
- As a minimum, the CCTV will capture a "head and shoulders" image of all persons entering the premises through the main public entrance.

Appropriate signage alerting customers to the use of CCTV shall be displayed in a conspicuous position at the premises.

A competent person trained in the use of and operation of the CCTV will be in attendance at the premise at all times that licensable activities are taking place. Said person will be able to fully operate the CCTV system and be able to download data in a recognised format when requested.

An incident register of any ejections from the premises will be maintained at the premises and any details of public order offences will be recorded. Said register will be made available upon request to an authorised officer.

Prior to any occasion on which licensable activities are to be carried on at the premises, a risk assessment will be carried out to determine whether door supervisors are required. An appropriate number of door supervisors will be utilised in accordance with said risk assessment.

The premises will have a written zero tolerance drugs policy which is enforced at all times.

c) Public safety

Any sales of alcohol made for consumption off the premises will be made in a sealed container.

d) The prevention of public nuisance

The management of the premises will ensure that the area immediately outside the entrance to the premises is kept clean, tidy and free from litter.

On any occasion that regulated entertainment is carried on at the premises, regular assessments of the noise emanating from the premises will be undertaken. Wherever said assessments indicate that noise is likely to cause nuisance to any local residents, remedial action will be taken.

Whenever regulated entertainment is taking place at the premises, doors and windows will be kept closed except for the purposes of access and egress.

Signs will be erected in prominent positions at public exits requiring customers to leave the premises and the area quietly.

e) The protection of children from harm

There shall be no persons under the age of eighteen permitted on the premises after 22:00 each evening.

There shall be no persons under the age of sixteen permitted on the premises after 20:00 unless they are accompanied by a responsible adult.

A "Challenge 25" Policy shall be adopted and enforced at the premises whereby any person who appears to be under the age of 25 shall be required to provide identification to prove that they are over the age of 18 before they are permitted to purchase alcohol. The only forms of acceptable identification will be:

- A Passport;
- A UK Photocard Driving Licence;
- Official ID card issued by HM Forces or EU bearing a photograph and the date of birth of the holder;
- Any other form of identification agreed with a representative of the Police Licensing Unit.

All staff who are involved in the sale of alcohol will be trained in relation to the "Challenge 25" policy upon the commencement of their employment, following which they will undertake refresher training at least once every twelve months. Said training will be documented and will be made available to an authorised officer upon request.

Checklist:

Please tick to indicate agreement

- I have made or enclosed payment of the fee. ☒
- I have enclosed the plan of the premises. ☒
- I have sent copies of this application and the plan to responsible authorities and others where applicable. ☒
- I have enclosed the consent form completed by the individual I wish to be designated premises supervisor, if applicable. ☒
- I understand that I must now advertise my application. ☒
- I understand that if I do not comply with the above requirements my application will be rejected. ☒
- ☐ [Applicable to all individual applicants, including those in a partnership which is not a limited liability partnership, but not companies or limited liability partnerships] I have included documents demonstrating my entitlement to work in the United Kingdom (please read note 15).

IT IS AN OFFENCE, UNDER SECTION 158 OF THE LICENSING ACT 2003, TO MAKE A FALSE STATEMENT IN OR IN CONNECTION WITH THIS APPLICATION. THOSE WHO MAKE A FALSE STATEMENT MAY BE LIABLE ON SUMMARY CONVICTION TO A FINE OF ANY AMOUNT.

IT IS AN OFFENCE UNDER SECTION 24B OF THE IMMIGRATION ACT 1971 FOR A PERSON TO WORK WHEN THEY KNOW, OR HAVE REASONABLE CAUSE TO BELIEVE, THAT THEY ARE DISQUALIFIED FROM DOING SO BY REASON OF THEIR IMMIGRATION STATUS. THOSE WHO EMPLOY AN ADULT WITHOUT LEAVE OR WHO IS SUBJECT TO CONDITIONS AS TO EMPLOYMENT WILL BE LIABLE TO A CIVIL PENALTY UNDER SECTION 15 OF THE IMMIGRATION, ASYLUM AND NATIONALITY ACT 2006 AND PURSUANT TO SECTION 21 OF THE SAME ACT, WILL BE COMMITTING AN OFFENCE WHERE THEY DO SO IN THE KNOWLEDGE, OR WITH REASONABLE CAUSE TO BELIEVE, THAT THE EMPLOYEE IS DISQUALIFIED.

Part 4 – Signatures (please read guidance note 11)

Signature of applicant or applicant's solicitor or other duly authorised agent (see guidance note 12). **If signing on behalf of the applicant, please state in what capacity.**

Declaration	<ul style="list-style-type: none">• [Applicable to individual applicants only, including those in a partnership which is not a limited liability partnership] I understand I am not entitled to be issued with a licence if I do not have the entitlement to live and work in the UK (or if I am subject to a condition preventing me from doing work relating to the carrying on of a licensable activity) and that my licence will become invalid if I cease to be entitled to live and work in the UK (please read guidance note 15).• The DPS named in this application form is entitled to work in the UK (and is not subject to conditions preventing him or her from doing work relating to a licensable activity) and I have seen a copy of his or her proof of entitlement to work, if appropriate (please see note 15)
Signature	
Date	31 st July 2019
Capacity	Solicitors & Duly Authorised Agents

For joint applications, signature of 2nd applicant or 2nd applicant's solicitor or other authorised agent (please read guidance note 13). **If signing on behalf of the applicant, please state in what capacity.**

Signature	
Date	
Capacity	

Contact name (where not previously given) and postal address for correspondence associated with this application (please read guidance note 14)

Malcolm Ireland, Head of Leisure & Licensing
Naphthens LLP, Solicitors
Darwen House, Walker Business Park
Walker Road
Blackburn

Post town	Blackburn	Postcode	BB1 2QE
Telephone number (if any)			
If you would prefer us to correspond with you by e-mail, your e-mail address (optional)			

Notes for Guidance

1. Describe the premises, for example the type of premises, its general situation and layout and any other information which could be relevant to the licensing objectives. Where your application includes off-supplies of alcohol and you intend to provide a place for consumption of these off-supplies, you must include a description of where the place will be and its proximity to the premises.
2. In terms of specific regulated entertainments please note that:
 - Plays: no licence is required for performances between 08:00 and 23.00 on any day, provided that the audience does not exceed 500.
 - Films: no licence is required for 'not-for-profit' film exhibition held in community premises between 08.00 and 23.00 on any day provided that the audience does not exceed 500 and the organiser (a) gets consent to the screening from a person who is responsible for the premises; and (b) ensures that each such screening abides by age classification ratings.
 - Indoor sporting events: no licence is required for performances between 08.00 and 23.00 on any day, provided that the audience does not exceed 1000.
 - Boxing or Wrestling Entertainment: no licence is required for a contest, exhibition or display of Greco-Roman wrestling, or freestyle wrestling between 08.00 and 23.00 on any day, provided that the audience does not exceed 1000. Combined fighting sports – defined as a contest, exhibition or display which combines boxing or wrestling with one or more martial arts – are licensable as a boxing or wrestling entertainment rather than an indoor sporting event.
 - Live music: no licence permission is required for:
 - a performance of unamplified live music between 08.00 and 23.00 on any day, on any premises.
 - a performance of amplified live music between 08.00 and 23.00 on any day on premises authorised to sell alcohol for consumption on those premises, provided that the audience does not exceed 500.
 - a performance of amplified live music between 08.00 and 23.00 on any day, in a workplace that is not licensed to sell alcohol on those premises, provided that the audience does not exceed 500.
 - a performance of amplified live music between 08.00 and 23.00 on any day, in a church hall, village hall, community hall, or other similar community premises, that is not licensed by a premises licence to sell alcohol, provided that (a) the audience does not exceed 500, and (b) the organiser gets consent for the performance from a person who is responsible for the premises.
 - a performance of amplified live music between 08.00 and 23.00 on any day, at the non-residential premises of (i) a local authority, or (ii) a school, or (iii) a hospital, provided that (a) the audience does not exceed 500, and (b) the organiser gets consent for the performance on the relevant premises from: (i) the local authority concerned, or (ii) the school or (iii) the health care provider for the hospital.

- Recorded Music: no licence permission is required for:
 - any playing of recorded music between 08.00 and 23.00 on any day on premises authorised to sell alcohol for consumption on those premises, provided that the audience does not exceed 500.
 - any playing of recorded music between 08.00 and 23.00 on any day, in a church hall, village hall, community hall, or other similar community premises, that is not licensed by a premises licence to sell alcohol, provided that (a) the audience does not exceed 500, and (b) the organiser gets consent for the performance from a person who is responsible for the premises.
 - any playing of recorded music between 08.00 and 23.00 on any day, at the non-residential premises of (i) a local authority, or (ii) a school, or (iii) a hospital, provided that (a) the audience does not exceed 500, and (b) the organiser gets consent for the performance on the relevant premises from: (i) the local authority concerned, or (ii) the school proprietor or (iii) the health care provider for the hospital.
 - Dance: no licence is required for performances between 08.00 and 23.00 on any day, provided that the audience does not exceed 500. However, a performance which amounts to adult entertainment remains licensable.
 - Cross activity exemptions: no licence is required between 08.00 and 23.00 on any day, with no limit on audience size for:
 - any entertainment taking place on the premises of the local authority where the entertainment is provided by or on behalf of the local authority;
 - any entertainment taking place on the hospital premises of the health care provider where the entertainment is provided by or on behalf of the health care provider;
 - any entertainment taking place on the premises of the school where the entertainment is provided by or on behalf of the school proprietor; and
 - any entertainment (excluding films and a boxing or wrestling entertainment) taking place at a travelling circus, provided that (a) it takes place within a moveable structure that accommodates the audience, and (b) that the travelling circus has not been located on the same site for more than 28 consecutive days.
3. Where taking place in a building or other structure please tick as appropriate (indoors may include a tent).
 4. For example the type of activity to be authorised, if not already stated, and give relevant further details, for example (but not exclusively) whether or not music will be amplified or unamplified.
 5. For example (but not exclusively), where the activity will occur on additional days during the summer months.
 6. For example (but not exclusively), where you wish the activity to go on longer on a particular day e.g. Christmas Eve.
 7. Please give timings in 24 hour clock (e.g. 16.00) and only give details for the days of the week when you intend the premises to be used for the activity.
 8. If you wish people to be able to consume alcohol on the premises, please tick 'on the premises'. If you wish people to be able to purchase alcohol to consume away

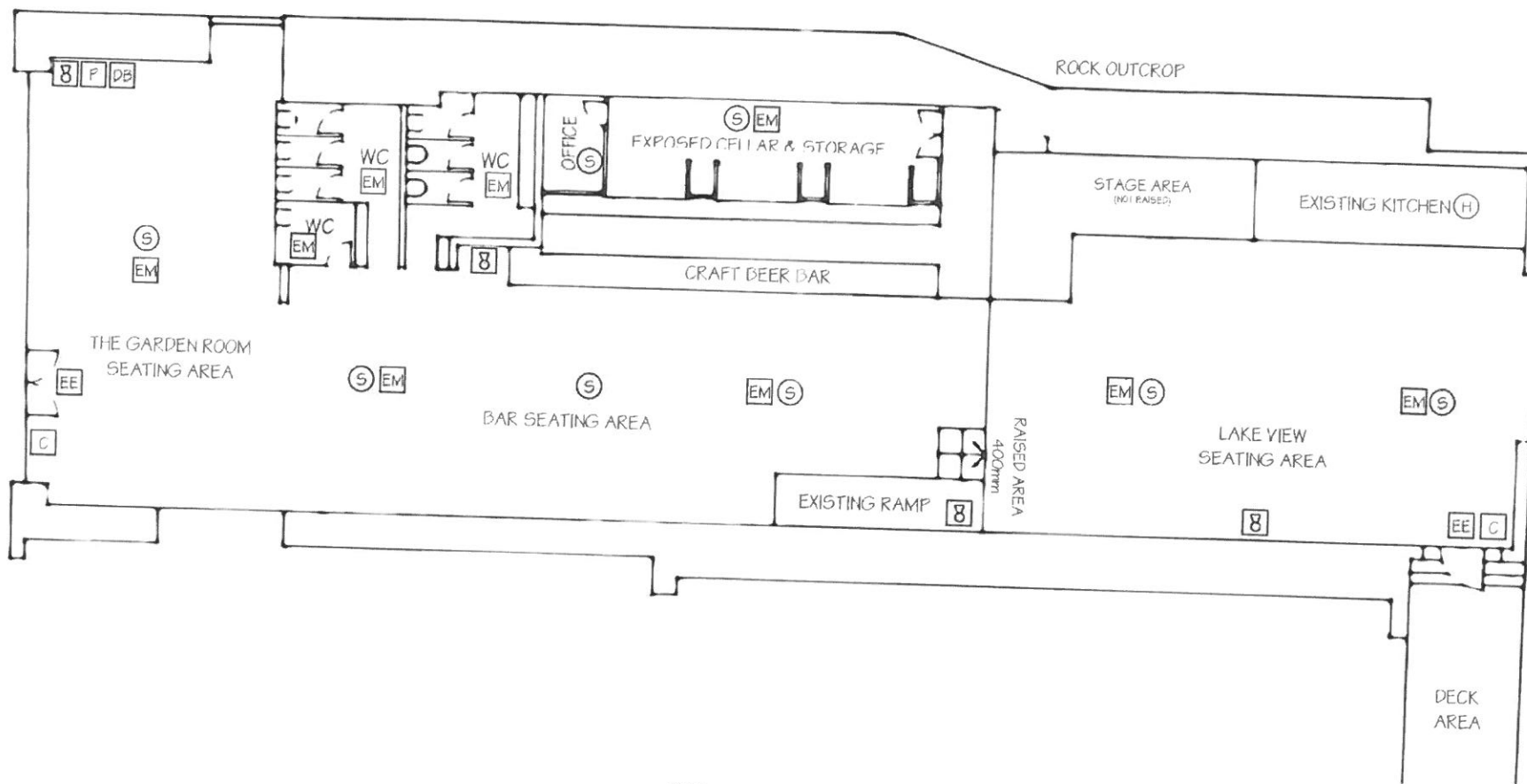

KEY:

- DB DISTRIBUTION BOARD & KEY SWITCHES
- EE EMERGENCY EXIT SIGN
- EM EMERGENCY BULKHEAD
- C MANUAL CALL POINT
- P FIRE ALARM PANEL
- S SOUNDER
- S SMOKE DETECTOR
- H HEAT DETECTOR

JUNE 2019

GENERAL PLAN LAYOUT FOR LICENSING

BOATERS CRAFT BEER BAR
BOWNESS ON WINDERMERE

SCALE @ A3 1:100