

**Application for a premises licence to be granted
under the Licensing Act 2003**



PLEASE READ THE FOLLOWING INSTRUCTIONS FIRST

Before completing this form please read the guidance notes at the end of the form.
If you are completing this form by hand please write legibly in block capitals. In all cases ensure that your answers are inside the boxes and written in black ink. Use additional sheets if necessary.
You may wish to keep a copy of the completed form for your records.

I/We Daphne Quinn

(Insert name(s) of applicant)

apply for a premises licence under section 17 of the Licensing Act 2003 for the premises described in Part 1 below (the premises) and I/we are making this application to you as the relevant licensing authority in accordance with section 12 of the Licensing Act 2003

Part 1 – Premises Details

Postal address of premises or, if none, ordnance survey map reference or description Platform (formerly known as 'The Copper Dog') Leece Ulverston Cumbria LA12 0QP			
Post town	Leece, Nr Ulverston	Post code	LA12 0QP

Telephone number at premises (if any)	N/A
Non-domestic rateable value of premises	£18,750

Part 2 - Applicant Details

Please state whether you are applying for a premises licence as
Please tick yes

- | | | |
|---|-------------------------------------|-----------------------------|
| a) an individual or individuals * | <input checked="" type="checkbox"/> | please complete section (A) |
| b) a person other than an individual * | | |
| i. as a limited company | <input type="checkbox"/> | please complete section (B) |
| ii. as a partnership | <input type="checkbox"/> | please complete section (B) |
| iii. as an unincorporated association or | <input type="checkbox"/> | please complete section (B) |
| iv. other (for example a statutory corporation) | <input type="checkbox"/> | please complete section (B) |
| c) a recognised club | <input type="checkbox"/> | please complete section (B) |
| d) a charity | <input type="checkbox"/> | please complete section (B) |

- e) the proprietor of an educational establishment ☐ please complete section (B)
- f) a health service body ☐ please complete section (B)
- g) a person who is registered under Part 2 of the Care Standards Act 2000 (c14) in respect of an independent hospital in Wales ☐ please complete section (B)
- ga) a person who is registered under Chapter 2 of Part 1 of the Health and Social Care Act 2008 (within the meaning of that Part) in an independent hospital in England ☐ please complete section (B)
- h) the chief officer of police of a police force in England and Wales ☐ please complete section (B)

* If you are applying as a person described in (a) or (b) please confirm:

Please tick yes

- I am carrying on or proposing to carry on a business which involves the use of the premises for licensable activities; or ☒
- I am making the application pursuant to a
 - statutory function or ☐
 - a function discharged by virtue of Her Majesty's prerogative ☐

(A) INDIVIDUAL APPLICANTS (fill in as applicable)

Mr <input type="checkbox"/>	Mrs <input type="checkbox"/>	Miss <input type="checkbox"/>	Ms <input checked="" type="checkbox"/>	Other Title (for example, Rev)	
Surname Quinn			First names Daphne		
I am 18 years old or over				<input checked="" type="checkbox"/> Please tick yes	
Current postal address if different from premises address					
Post Town				Postcode	
Daytime contact telephone number					
E-mail address (optional)					

SECOND INDIVIDUAL APPLICANT (if applicable)

Mr <input type="checkbox"/>	Mrs <input type="checkbox"/>	Miss <input type="checkbox"/>	Ms <input type="checkbox"/>	Other Title (for example, Rev)	
Surname			First names		

I am 18 years old or over		<input type="checkbox"/> Please tick yes	
Current postal address if different from premises address			
Post Town		Postcode	
Daytime contact telephone number			
E-mail address (optional)			

(B) OTHER APPLICANTS

Please provide name and registered address of applicant in full. Where appropriate please give any registered number. In the case of a partnership or other joint venture (other than a body corporate), please give the name and address of each party concerned.

Name
Address
Registered number (where applicable)
Description of applicant (for example, partnership, company, unincorporated association etc.)
Telephone number (if any)
E-mail address (optional)

Part 3 Operating Schedule

When do you want the premises licence to start?

Day		Month		Year	
1	1	0	1	0	2

If you wish the licence to be valid only for a limited period, when do you want it to end?

Day		Month		Year	

Please give a general description of the premises (please read guidance note1)

Country pub/restaurant located in Leece village with its own car park. The area of the property which is presented for licensing consists internally of a main bar with an adjoining room and a separate dining room/conservatory, and externally of a patio outside the main entrance to the bar (extending to a sheltered smoking area) and a beer garden, both of which will have seating for dining and/or drinking (including alcoholic beverages).

If 5,000 or more people are expected to attend the premises at any one time, please state the number expected to attend.

N/A

What licensable activities do you intend to carry on from the premises?

(Please see sections 1 and 14 of the Licensing Act 2003 and Schedules 1 and 2 to the Licensing Act 2003)

Provision of regulated entertainment

Please tick yes

- | | |
|---|-------------------------------------|
| a) plays (if ticking yes, fill in box A) | <input type="checkbox"/> |
| b) films (if ticking yes, fill in box B) | <input type="checkbox"/> |
| c) indoor sporting events (if ticking yes, fill in box C) | <input checked="" type="checkbox"/> |
| d) boxing or wrestling entertainment (if ticking yes, fill in box D) | <input type="checkbox"/> |
| e) live music (if ticking yes, fill in box E) | <input checked="" type="checkbox"/> |
| f) recorded music (if ticking yes, fill in box F) | <input checked="" type="checkbox"/> |
| g) performances of dance (if ticking yes, fill in box G) | <input checked="" type="checkbox"/> |
| h) anything of a similar description to that falling within (e), (f) or (g) (if ticking yes, fill in box H) | <input type="checkbox"/> |

Provision of entertainment facilities:

- | | |
|---|-------------------------------------|
| i) making music (if ticking yes, fill in box I) | <input checked="" type="checkbox"/> |
| j) dancing (if ticking yes, fill in box J) | <input checked="" type="checkbox"/> |
| k) entertainment of a similar description to that falling within (i) or (j) (if ticking yes, fill in box K) | <input type="checkbox"/> |

Provision of late night refreshment (if ticking yes, fill in box L)

☒

Supply of alcohol (if ticking yes, fill in box M)

☒

In all cases complete boxes N, O and P

A

Plays Standard days and timings (please read guidance note 6)			Will the performance of a play take place indoors or outdoors or both – please tick (please read guidance note 2)	Indoors	<input type="checkbox"/>
				Outdoors	<input type="checkbox"/>
				Both	<input type="checkbox"/>
Day	Start	Finish	Please give further details here (please read guidance note 3)		
Mon					
Tue					
Wed					
Thur			State any seasonal variations for performing plays (please read guidance note 4)		
Fri			Non standard timings. Where you intend to use the premises for the performance of plays at different times to those listed in the column on the left, please list (please read guidance note 5)		
Sat					
Sun					

B

Films Standard days and timings (please read guidance note 6)			<u>Will the exhibition of films take place indoors or outdoors or both – please tick</u> (please read guidance note 2)	Indoors	<input type="checkbox"/>
				Outdoors	<input type="checkbox"/>
				Both	<input type="checkbox"/>
Day	Start	Finish	<u>Please give further details here</u> (please read guidance note 3)		
Mon					
Tue			<u>State any seasonal variations for the exhibition of films</u> (please read guidance note 4)		
Wed					
Thur			<u>Non standard timings. Where you intend to use the premises for the exhibition of films at different times to those listed in the column on the left, please list</u> (please read guidance note 5)		
Fri					
Sat					
Sun					

C

Indoor sporting events Standard days and timings (please read guidance note 6)			<u>Please give further details</u> (please read guidance note 3) Possibility of <i>occasional</i> bookings for games which may be classified as 'sports'.
Day	Start	Finish	
Mon	1200	2359	
Tue	1200	2359	<u>State any seasonal variations for indoor sporting events</u> (please read guidance note 4) N/A
Wed	1200	2359	
Thur	1200	2359	<u>Non standard timings. Where you intend to use the premises for indoor sporting events at different times to those listed in the column on the left, please list</u> (please read guidance note 5) N/A
Fri	1200	2359	
Sat	1200	2359	
Sun	1200	2359	

D

Boxing or wrestling entertainments Standard days and timings (please read guidance note 6)			Will the boxing or wrestling entertainment take place indoors or outdoors or both – please tick (please read guidance note 2)		Indoors <input type="checkbox"/>
					Outdoors <input type="checkbox"/>
Day	Start	Finish			Both <input type="checkbox"/>
Mon			Please give further details here (please read guidance note 3)		
Tue					
Wed			State any seasonal variations for boxing or wrestling entertainment (please read guidance note 4)		
Thur					
Fri			Non standard timings. Where you intend to use the premises for boxing or wrestling entertainment at different times to those listed in the column on the left, please list (please read guidance note 5)		
Sat					
Sun					

E

Live music Standard days and timings (please read guidance note 6)			Will the performance of live music take place indoors or outdoors or both – please tick (please read guidance note 2)	Indoors	<input checked="" type="checkbox"/>
				Outdoors	<input type="checkbox"/>
				Both	<input type="checkbox"/>
Day	Start	Finish			
Mon	1100	0100	Please give further details here (please read guidance note 3) Bands/singers/artists/etc may occasionally play either amplified or unamplified for the entertainment of patrons and/or private parties ← (All given finishing times fall on the following day)		
Tue	1100	0100			
Wed	1100	0100	State any seasonal variations for the performance of live music (please read guidance note 4) N/A		
Thur	1100	0100			
Fri	1100	0100	Non standard timings. Where you intend to use the premises for the performance of live music at different times to those listed in the column on the left, please list (please read guidance note 5) N/A		
Sat	1100	0100			
Sun	1100	0100			

F

Recorded music Standard days and timings (please read guidance note 6)			<u>Will the playing of recorded music take place indoors or outdoors or both – please tick</u> (please read guidance note 2)	Indoors	<input checked="" type="checkbox"/>
				Outdoors	<input type="checkbox"/>
				Both	<input type="checkbox"/>
Day	Start	Finish			
Mon	1100	0100	<u>Please give further details here</u> (please read guidance note 3) Amplified background music will be played in the bar, its adjoining room, and the dining room/conservatory. ← (All given finishing times fall on the following day)		
Tue	1100	0100			
Wed	1100	0100	<u>State any seasonal variations for the playing of recorded music</u> (please read guidance note 4)		
Thur	1100	0100			
Fri	1100	0100	<u>Non standard timings. Where you intend to use the premises for the playing of recorded music at different times to those listed in the column on the left, please list</u> (please read guidance note 5) Christmas Eve: 1100 - 0200 on the following day Christmas Day: 1100 - 0200 on the following day New Year's Eve: 1100 - 0200 on the following day		
Sat	1100	0100			
Sun	1100	0100			

G

Performances of dance Standard days and timings (please read guidance note 6)			<u>Will the performance of dance take place indoors or outdoors or both – please tick</u> (please read guidance note 2)		Indoors	<input checked="" type="checkbox"/>
					Outdoors	<input type="checkbox"/>
Day	Start	Finish			Both	<input type="checkbox"/>
Mon	1100	0100	<u>Please give further details here</u> (please read guidance note 3) Possibility of very occasional dance performances. <i>(All given finishing times fall on the following day)</i>			
Tue	1100	0100				
Wed	1100	0100	<u>State any seasonal variations for the performance of dance</u> (please read guidance note 4) N/A			
Thur	1100	0100				
Fri	1100	0100	<u>Non standard timings. Where you intend to use the premises for the performance of dance at different times to those listed in the column on the left, please list</u> (please read guidance note 5) N/A			
Sat	1100	0100				
Sun	1100	0100				

H

Anything of a similar description to that falling within (e), (f) or (g) Standard days and timings (please read guidance note 6)			<u>Please give a description of the type of entertainment you will be providing</u>	
Day	Start	Finish	<u>Will this entertainment take place indoors or outdoors or both – please tick</u> (please read guidance note 2)	Indoors <input type="checkbox"/>
Mon				Outdoors <input type="checkbox"/>
				Both <input type="checkbox"/>
Tue			<u>Please give further details here</u> (please read guidance note 3)	
Wed				
Thur			<u>State any seasonal variations for entertainment of a similar description to that falling within (e), (f) or (g)</u> (please read guidance note 4)	
Fri				
Sat			<u>Non standard timings. Where you intend to use the premises for the entertainment of a similar description to that falling within (e), (f) or (g) at different times to those listed in the column on the left, please list</u> (please read guidance note 5)	
Sun				

Provision of facilities for making music Standard days and timings (please read guidance note 6)			<u>Please give a description of the facilities for making music you will be providing</u> Visiting bands, musicians, artists etc (as per section E) would be provided with performance space in the bar, its adjoining room and/or the dining room/conservatory in addition to the possible loan of auxiliary equipment such as music stands, amplification etc.	
			<u>Will the facilities for making music be indoors or outdoors or both – please tick</u> (please read guidance note 2)	
Day	Start	Finish	Indoors	<input checked="" type="checkbox"/>
			Outdoors	<input type="checkbox"/>
			Both	<input type="checkbox"/>
Mon	1100	0100	<u>Please give further details here</u> (please read guidance note 3) As outlined above, visiting bands, musicians, artists etc would be provided with adequate space to perform in addition to the possible loan of auxiliary equipment such as music stands, amplification etc. ← (All given finishing times fall on the following day)	
Tue	1100	0100		
Wed	1100	0100	<u>State any seasonal variations for the provision of facilities for making music</u> (please read guidance note 4) N/A	
Thur	1100	0100		
Fri	1100	0100	<u>Non standard timings. Where you intend to use the premises for provision of facilities for making music at different times to those listed in the column on the left, please list</u> (please read guidance note 5) N/A	
Sat	1100	0100		
Sun	1100	0100		

J

Provision of facilities for dancing Standard days and timings (please read guidance note 6)			<u>Will the facilities for dancing be indoors or outdoors or both – please tick</u> (see guidance note 2)	Indoors <input checked="" type="checkbox"/>
				Outdoors <input type="checkbox"/>
				Both <input type="checkbox"/>
			<u>Please give a description of the facilities for dancing you will be providing</u> Dance performers as outlined in section G would be provided with space in the bar, its adjoining room and/or the dining room/conservatory for their routine and possibly allowed to use audio-visual equipment installed in the premises.	
Day	Start	Finish		
Mon	1100	0100	<u>Please give further details here</u> (please read guidance note 3) Additionally, patrons may occasionally wish to dance in celebration of special events other than those listed under 'non standard timings'. ← (All given finishing times fall on the following day)	
Tue	1100	0100		
Wed	1100	0100	<u>State any seasonal variations for providing dancing facilities</u> (please read guidance note 4)	
Thur	1100	0100		
Fri	1100	0100	<u>Non standard timings. Where you intend to use the premises for the provision of facilities for dancing entertainment at different times to those listed in the column on the left, please list</u> (please read guidance note 5) New Year's Eve: 1100-0200 of the following day	
Sat	1100	0100		
Sun	1100	0100		

K

Provision of facilities for entertainment of a similar description to that falling within i or j Standard days and timings (please read guidance note 6)			<u>Please give a description of the type of entertainment facility you will be providing</u>	
Day	Start	Finish	<u>Will the entertainment facility be indoors or outdoors or both – please tick</u> (please read guidance note 2)	Indoors <input type="checkbox"/>
Mon				Outdoors <input type="checkbox"/>
				Both <input type="checkbox"/>
Tue			<u>Please give further details here</u> (please read guidance note 3)	
Wed				
Thur			<u>State any seasonal variations for the provision of facilities for entertainment of a similar description to that falling within i or j</u> (please read guidance note 4)	
Fri				
Sat			<u>Non standard timings. Where you intend to use the premises for the provision of facilities for entertainment of a similar description to that falling within i or j at different times to those listed in the column on the left, please list</u> (please read guidance note 5)	
Sun				



L

Late night refreshment Standard days and timings (please read guidance note 6)			Will the provision of late night refreshment take place indoors or outdoors or both – please tick (please read guidance note 2)	Indoors	<input checked="" type="checkbox"/>
				Outdoors	<input type="checkbox"/>
				Both	<input type="checkbox"/>
Day	Start	Finish			
Mon	2300	0100	<u>Please give further details here</u> (please read guidance note 3) Meals, snacks and hot beverages served in any internal room. <i>(All given finishing times fall on the following day)</i>		
Tue	2300	0100			
Wed	2300	0100	<u>State any seasonal variations for the provision of late night refreshment</u> (please read guidance note 4) N/A		
Thur	2300	0100			
Fri	2300	0100	<u>Non standard timings. Where you intend to use the premises for the provision of late night refreshment at different times, to those listed in the column on the left, please list</u> (please read guidance note 5) Christmas Eve: 2300-0200 of the following day Christmas Day: 2300-0200 of the following day New Year's Eve: 2300-0200 of the following day		
Sat	2300	0100			
Sun	2300	0100			

M

Supply of alcohol Standard days and timings (please read guidance note 6)			Will the supply of alcohol be for consumption (Please tick box) (please read guidance note 7)	On the premises	<input type="checkbox"/>
				Off the premises	<input type="checkbox"/>
				Both	<input checked="" type="checkbox"/>
Day	Start	Finish	State any seasonal variations for the supply of alcohol (please read guidance note 4)		
Mon	1100	0100	N/A ← (All given finishing times fall on the following day)		
Tue	1100	0100			
Wed	1100	0100			
Thur	1100	0100	Non standard timings. Where you intend to use the premises for the supply of alcohol at different times to those listed in the column on the left, please list (please read guidance note 5)		
Fri	1100	0100	Christmas Eve: 1100-0200 of the following day Christmas Day: 1100-0200 of the following day New Year's Eve: 1100-0200 of the following day		
Sat	1100	0100			
Sun	1100	0100			

State the name and details of the individual whom you wish to specify on the licence as premises supervisor

Name Daphne Quinn	
Address 	
Postcode	
Personal Licence number (if known)	
Issuing licensing authority (if known) Barrow Borough Council	

N

Please highlight any adult entertainment or services, activities, other entertainment or matters ancillary to the use of the premises that may give rise to concern in respect of children (please read guidance note 8)

N/A.

O

Hours premises are open to the public Standard days and timings (please read guidance note 6)			<u>State any seasonal variations</u> (please read guidance note 4) N/A, however please note that these are the maximum opening hours and the premises are likely to close earlier on most days.
Day	Start	Finish	← (All given finishing times fall on the following day)
Mon	1100	0130	
Tue	1100	0130	
Wed	1100	0130	
Thur	1100	0130	<u>Non standard timings. Where you intend the premises to be open to the public at different times from those listed in the column on the left, please list</u> (please read guidance note 5) Christmas Eve: 1100-0230 of the following day Christmas Day: 1100-0230 of the following day New Year's Eve: 1100-0230 of the following day
Fri	1100	0130	
Sat	1100	0130	
Sun	1100	0130	

P Describe the steps you intend to take to promote the four licensing objectives:

a) General – all four licensing objectives (b,c,d,e) (please read guidance note 9)

- 1) We shall exercise good, sound and competent management to ensure that all of the more specific steps detailed below are enacted consistently and effectively by staff
- 2) The below points will not be exclusive, and we shall readily adopt further measures if we feel that they would help us to better promote the licensing objectives

b) The prevention of crime and disorder

- 1) We shall refuse to serve anyone who appears to be have already consumed excessive amounts of alcohol
- 2) Unruly and/or violent patrons will be asked to leave the premises, and a record of the matter will be logged in the Crime and Disorder Incident book
- 3) To discourage drink-driving, we shall offer to call patrons a taxi at the end of their visit and allow them to park their car on our grounds overnight

c) Public safety

- 1) Fire detection and control equipment, (such as alarms, exits, emergency lighting, extinguishers), will regularly inspected to ensure that they are easily accessible and working correctly
- 2) Staff will be trained to know the evacuation routine for the premises so that they can assist customers in the event of a fire or other emergency
- 3) The premises will be kept in a good state of repair, with particular attention paid to areas which could increase the risk of trips and falls, (eg, loose paving stones, unsound guard rails)

d) The prevention of public nuisance

- 1) Customers leaving late in the evening will be asked to keep noise to a minimum and to be considerate towards neighbouring residents
- 2) In the later evening, background music will be played at a lower volume and doors/windows will be shut to keep outside noise disturbance to a minimum
- 3) Outside areas will be regularly cleaned of rubbish, (especially in the summer months when patrons may eat/drink outdoors), and cigarette bins will be provided for smokers

e) The protection of children from harm

- 1) We shall operate a strict 'Challenge 25' policy to prevent underage drinking, with all staff being rigorously trained in the correct methods of age verification
- 2) Groups of young drinkers will be refused alcohol unless all members of that group have valid identification, preventing 18+ year olds 'passing out' drinks to underage friends
- 3) Parents will be reminded that it is illegal for minors to consume alcohol on the premises, and we shall refuse to supply them if we suspect this advice will be ignored
- 4) Under 16 year olds will be refused entry unless accompanied by a responsible adult

Please tick yes

- I have made or enclosed payment of the fee ☒
- I have enclosed the plan of the premises ☒
- I have sent copies of this application and the plan to responsible authorities and others where applicable ☒
- I have enclosed the consent form completed by the individual I wish to be premises supervisor, if applicable ☐
- I understand that I must now advertise my application ☒
- I understand that if I do not comply with the above requirements my application will be rejected ☒

IT IS AN OFFENCE, LIABLE ON CONVICTION TO A FINE UP TO LEVEL 5 ON THE STANDARD SCALE, UNDER SECTION 158 OF THE LICENSING ACT 2003 TO MAKE A FALSE STATEMENT IN OR IN CONNECTION WITH THIS APPLICATION

Part 4 – Signatures (please read guidance note 10)





Signature of applicant or applicant's solicitor or other duly authorised agent (See guidance note 11). If signing on behalf of the applicant please state in what capacity.

Signature	
Date	6th September '12.
Capacity	

For joint applications signature of 2nd applicant or 2nd applicant's solicitor or other authorised agent. (please read guidance note 12). If signing on behalf of the applicant please state in what capacity.

Signature	
Date	
Capacity	

Contact name (where not previously given) and postal address for correspondence associated with this application (please read guidance note 13)

			
Post town		Post code	
Telephone number (if any)			
If you would prefer us to correspond with you by e-mail your e-mail address (optional)			

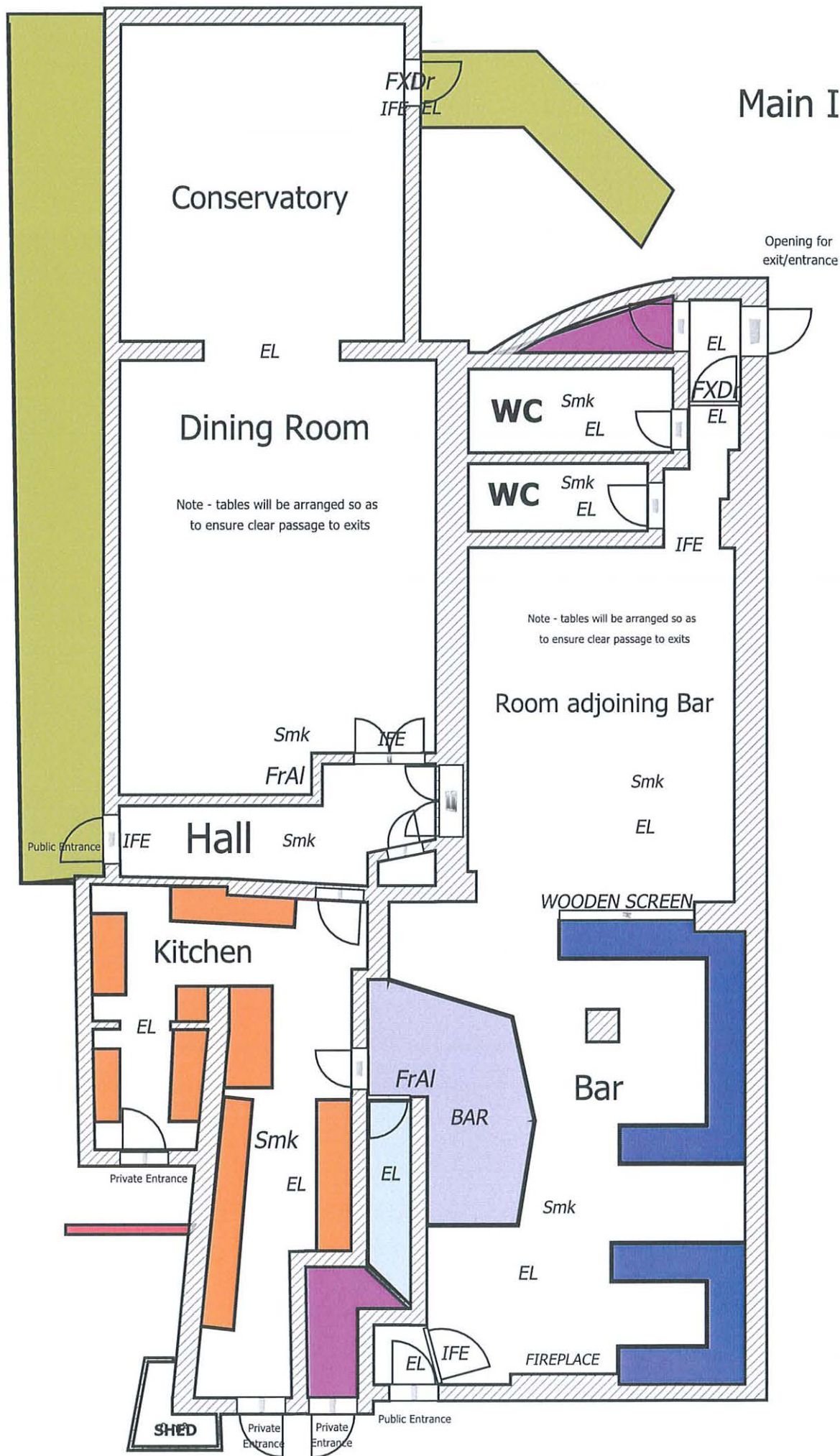

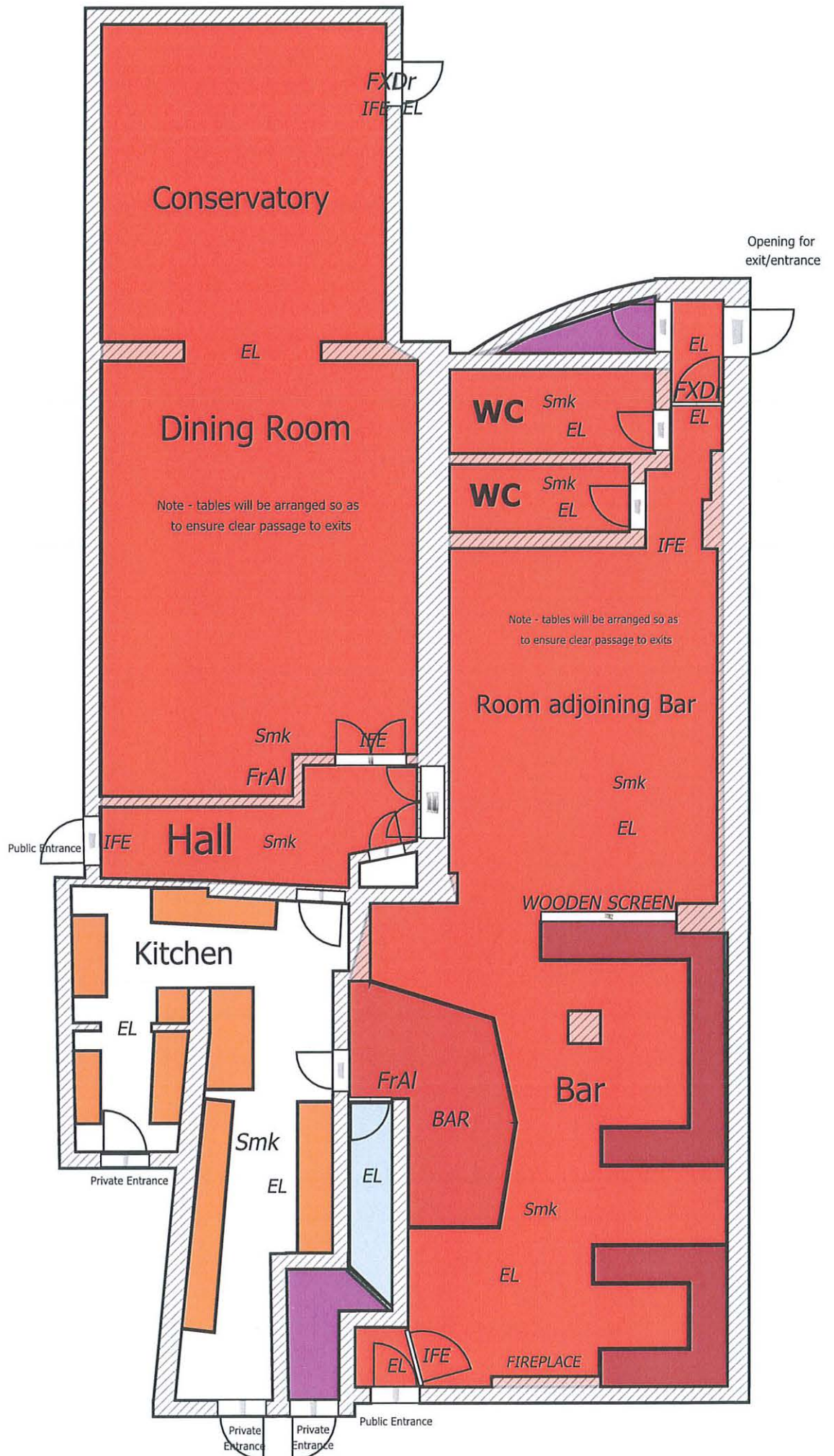

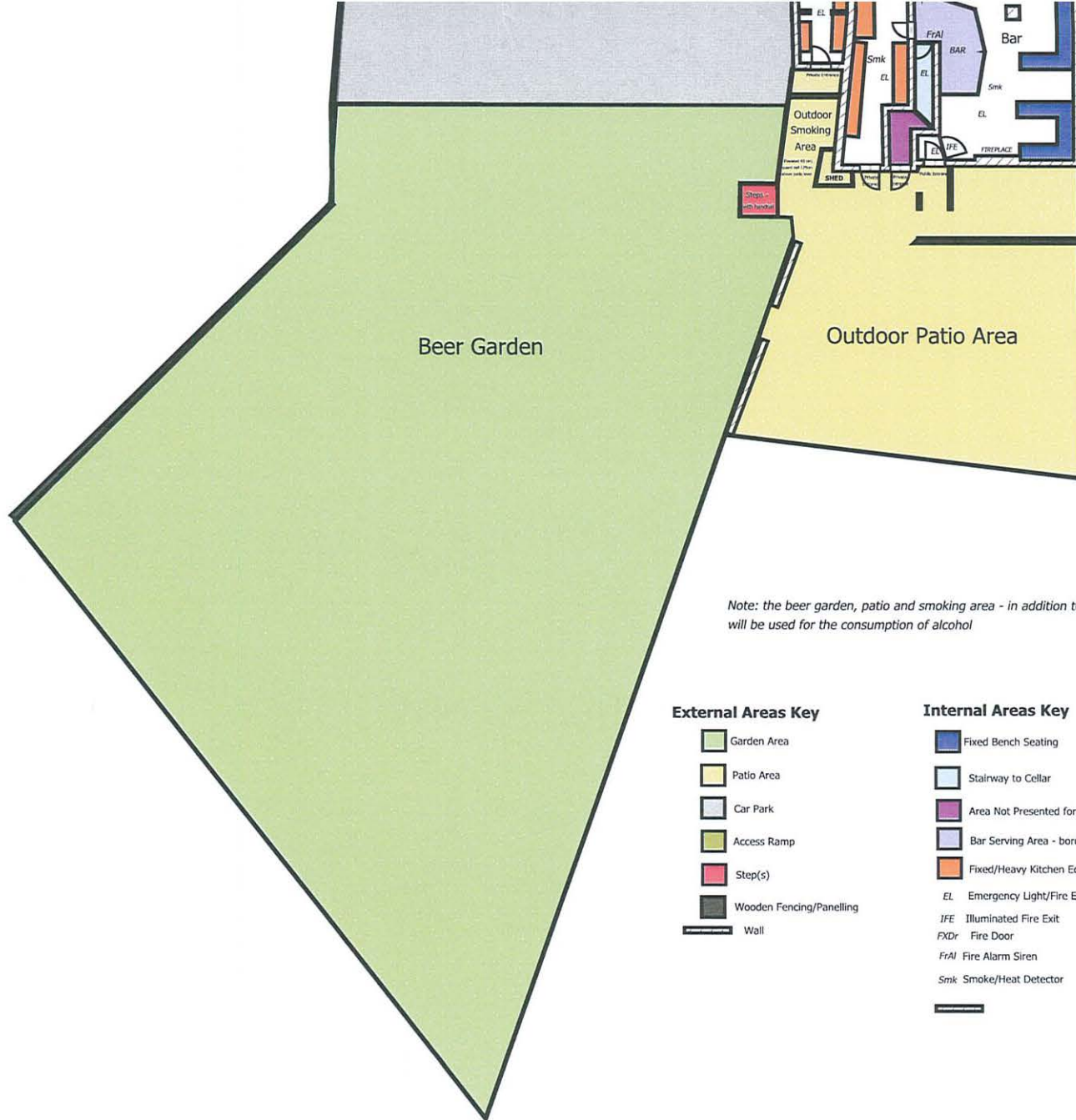

Note: the beer garden, patio and smoking area - in addition to all indoor areas - will be used for the consumption of alcohol

External Areas Key

- Garden Area
- Patio Area
- Car Park
- Access Ramp
- Step(s)
- Wooden Fencing/Panelling
- Wall

Internal Areas Key

- Fixed Bench Seating
- Stairway to Cellar
- Area Not Presented for Licensing
- Bar Serving Area - bordered by wooden bar top
- Fixed/Heavy Kitchen Equipment/Storage
- EL Emergency Light/Fire Exit Sign
- IFE Illuminated Fire Exit
- FXDr Fire Door
- FrAl Fire Alarm Siren
- Smk Smoke/Heat Detector

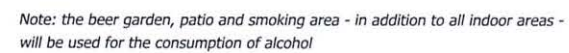

Internal Areas Key

Downloaded from